



SCPH-30001 R
SCPH-30002 R
SCPH-30003 R
SCPH-30004 R
SCPH-30005 R
SCPH-30006 R
SCPH-30007 R

SCPH-30000 R series

SERVICE MANUAL

4th Edition

for GH015(12/22) MOUNT

(F-type model)

PlayStation®2



Sony Computer Entertainment Inc.
Quality Assurance Department
Published in Japan ©12.2001. 9-927-093-51

NOTICE

Copyright by Sony Computer Entertainment Inc. All rights reserved. No reproduced and transferred required except permission by Sony Computer Entertainment Inc. No commercial use and rental required.

REVISIONS.

This manual compiled by second edition of SCPH-30000 R series D type and F type models design data. Design and Specification will be subject to changed without notice. The latest versions of service manual, Technical memo, Technical information should be used together.

SAFETY-RELATED COMPONENT WARNING !!

COMPONENTS IDENTIFIED BY MARK \triangle OR DOTTED LINE WITH MARK \triangle ON THE SCHEMATIC DIAGRAMS AND IN THE PARTS LIST ARE CRITICAL TO SAFE OPERATION. REPLACE THESE COMPONENTS WITH SONY PARTS WHOSE PART NUMBERS APPEAR AS SHOWN IN THIS MANUAL OR IN SUPPLEMENTS PUBLISHED BY SONY.

ATTENTION AU COMPOSANT AYANT RAPPORT À LA SÉCURITÉ !

LES COMPOSANTS IDENTIFIÉS PAR UNE MARQUE \triangle SUR LES DIAGRAMMES SCHÉMATIQUES ET LA LISTE DES PIÈCES SONT CRITIQUES POUR LA SÉCURITÉ DE FONCTIONNEMENT. NE REMPLACER CES COMPOSANTS QUE PAR DES PIÈCES SONY DONT LES NUMÉROS SONT DONNÉS DANS CE MANUEL OU DANS LES SUPPLÉMENTS UBLIÉS PAR SONY.

CAUTION

Replace the battery with a Sony CR2032 battery. Use of any other type of battery may present the risk of fire or explosion. The battery may explode if mistreated. Do not recharge, disassemble, or dispose of in fire.

CAUTION

The use of optical instruments with this product will increase eye Hazard. As the laser beam used in this CD/DVD player is harmful To eyes, do not attempt to disassemble the cabinet. Refer servicing to qualified personnel only.

WARNING !!

WHEN SERVICING, DO NOT APPROACH THE LASER EXIT WITH THE EYE TOO CLOSELY. IN CASE IT IS NECESSARY TO CONFIRM LASER BEAM EMISSION, BE SURE TO OBSERVE FROM A DISTANCE OF MORE THAN 25cm FROM THE SURFACE OF THE OBJECTIVE LENS ON THE OPTICAL PICK-UP BLOCK.

CAUTION

Use of controls or adjustments or performance of procedures other than those specified herein may result in hazardous radiation exposure.

CAUTION for electric shock

When power is ON, Don't touch to Power supply block, AC-inlet, Power switch and so on, not to get an electric shock at repair.

CAUTION for burning

When current is supplied, Some of part surface temperature like EE, GS, Regulator-IC, power supply, Optical device and so on. These part surface is become high temperature condition. When it repair, Don't touch them at a time during it surface is high temperature condition to take prevent against burning. Do repair after it is cooled down enough.

CAUTION

Danger of explosion if battery is incorrectly replaced. Replace only with the same or equivalent type recommended by the manufacturer. Discard used batteries according to the manufacturer's instructions.

ADVARSEL!

Lithiumbatteri - Eksplosjonsfare ved feilagtig håndtering. Udskiftning må kun ske med batteri af samme fabrikat og type. Levér det brugte batteri tilbage til leverandøren.

ADVARSEL

Eksplosjonsfare ved feilaktig skifte av batteri. Benytt samme batteritype eller en tilsvarende type anbefalt av apparatfabrikanten. Brukte batterier kasseres i henhold til fabrikantens instruksjoner.

VARNING

Explosionsfara vid felaktigt batteritype. Använd samma batterityp eller en ekvivalent typ som rekommenderas av apparattillverkaren. Kassera använt batteri enligt fabrikantens instruktion.

VAROITUS

Paristo voi räjähtää, jos se on virheellisesti asennettu. Vaihda paristo ainoastaan valmistajan suosittelemaan tyyppiin. Hävitä käytetty paristo valmistajan ohjeiden mukaisesti.

SAFETY CHECK-OUT

After correcting the original service problem, perform the following safety checks before releasing the set to the customer:

1. Check the area of your repair for unsoldered or cold-soldered connections. Check the entire board surface for solder splashes and bridges.
2. Check the inter board wiring to ensure that no wires are "pinched" or contact high-wattage resistors.
3. Look for unauthorized replacement parts, particularly transistors, that were installed during a previous repair. Point them out to the customer and recommend their replacement.
4. Look for parts which, though functioning, show obvious signs of deterioration. Point them out of the customer and recommend their replacement.
5. Check the line cord for cracks and abrasion. Recommend the replacement of any such line cord to the customer.
6. Check the b+ voltage to see it is at the values specified.
7. Check the antenna terminals, metal trim, "metalized" knobs, screws, and all other exposed metal parts for ac leakage. Check leakage as described below.

LEAKAGE

The AC leakage from any exposed metal part to earth ground and from all exposed metal parts to any exposed metal part having a Return to chassis, must not exceed 0.5 mA (500 micro-amperes). Leakage current can be measured by any one of three methods.

1. A commercial leakage tester, such as the SIMPSON 229 or RCA WT-540A. Follow the manufacturers' instructions to use these instruments.
2. A battery-operated AC milli-ammeter. The Data Precision 245 digital multi-meter is suitable for this job.
3. Measuring the voltage drop across a resistor by means of a VOM or battery-operated ac voltmeter. The "limit" indication is 0.75V, so analog meters must have an accurate low-voltage scale. The SIMPSON 250 and SANWA SH-63TRD are examples of a passive VOM that is suitable. Nearly all battery operated digital multi-meters that have a 2V AC range are suitable.

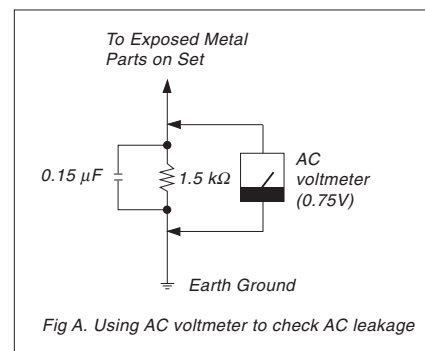

NOTIFICATION for environmental assessment

This model is CR2032 lithium battery onboard inside on the GB MOUNT or GH MOUNT as Timer backup power. CR2032 life may be about 5 to 8 years, so you have very few need for changing to new one. But if you have necessary to replaced to new one or disassemble for scrapping, you have to keep your country law, regulation, standard, etc. of environmental assessment and safety.

TABLE OF CONTENTS

SCPH-30000 R series F-type model with GH015(12/22) MOUNT

1. SPECIFICATIONS	GH015(12/22)- 4
2. SUPPLIED ACCESSORIES AND PACKING BLOCK	GH015(12/22)- 5
3. INSTRUCTION MANUAL BLOCK	GH015(12/22)- 7
4. EXPLODED VIEWS	
Overall and Main Block	GH015(12/22)- 8
MD Block	GH015(12/22)-11
GH Mount Block and Shield (A) Assy Block	GH015(12/22)-12
Switch Assy Block	GH015(12/22)-13
Power Switch, Fan and Rear Panel Assy Block	GH015(12/22)-14
5. Block Diagram	GH015(12/22)-15
6. Printed Wiring Boards and Schematic Diagrams	
Note for Printed Wiring Boards and Schematic Diagrams	GH015(12/22)-16
GH015(12/22) Mount	GH015(12/22)-17
Electrical Parts List for GH015(12/22) Mount	GH015(12/22)-28
Switch Mount	GH015(12/22)-37

1. SPECIFICATIONS

General

Power requirements

120 V AC, 60 Hz	for SCPH-30001 R
220 -240 V AC, 50/60 Hz	
	for SCPH-30002 R/-30003 R/-30004 R
220 V AC, 50/60 Hz	for SCPH-30005 R
220 -240 V AC, 50/60 Hz	for SCPH-30006 R
110 V AC, 50/60 Hz	for SCPH-30007 R

Power consumption

79 W	for SCPH-30001 R
50 W	
	for SCPH-30002 R/-30003 R/-30004 R
	SCPH-30005 R/-30006 R
47W	for SCPH-30007 R

Dimensions

301 x 78 x 182 mm (w/h/d)

Mass

2.4 kg

Inputs/Outputs on the front

Controller ports (2)
Memory card slots (2)
USB ports (2)
S400 (i-Link) port (1)

Inputs/Outputs on the rear

HDD bay slot (1)

Outputs on the rear

AV Multi out port (1)
RGB, Ycber, Y/C, Composite-video,
Audio-L/R, XGA
Digital out port (1)
Optical audio

Supplied accessories

AC power cord (1)
A/V connecting cable (1)
Dualshock2 Analog controller (1)
Euro-AV Connector (1)
for SCPH-30003 R/-30004 R

2. SUPPLIED ACCESSORIES AND PACKING BLOCK

NOTE :

- Due to standardization, replacements in the parts list may be different from the parts specified in the diagrams or the components used on the set.
- -XX and -X mean standardized parts, so they may have some difference from the original one.
- RESISTORS
METAL : Metal-film resistor.
F : nonflammable
Unit is Ω.

- SEMICONDUCTORS
In each case, u : μ, for example :
uA .. : μA .. uPA .. : μPA ..
uPB.. : μPB.. uPC.. : μPC .. uPD .. : μPD ..
- CAPACITORS
uF : μF
- COILS
uH : μH

The components identified by mark Δ or dotted line with mark. Δ are critical for safety. Replace only with part number specified.

SUPPLIED ACCESSORIES and PACKING GROUP

PLACE CODE #23

SCPH-30001 R F-type model ACCESSORIES & PACKING GROUP

Ref.	Part No.	Description
Δ AC	1-790-108-21	CORD, POWER
AV	1-792-028-11	AV CABLE (Integrated audio/video)
AV	1-792-028-21	AV CABLE (Integrated audio/video)
AV	1-792-028-31	AV CABLE (Integrated audio/video)
AV	1-792-028-41	AV CABLE (Integrated audio/video)
AV	1-792-028-51	AV CABLE (Integrated audio/video)
AV	1-792-028-61	AV CABLE (Integrated audio/video)
CONT	1-792-238-72	ANALOG CONTROLLER (DUALSHOCK 2)
CONT	1-823-069-11	ANALOG CONTROLLER (DUALSHOCK 2)
CONT	1-823-091-11	ANALOG CONTROLLER (DUALSHOCK 2)
CONT	1-823-552-11	ANALOG CONTROLLER (DUALSHOCK 2)
CU	3-064-714-01	CUSHION
CU2	3-064-713-01	CUSHION 2
SH	3-065-170-01	SHEET, PROTECTION
CA	3-071-632-11	INDIVIDUAL, CARTON
MC	3-071-633-01	MASTER CARTON, 3 SETS
TA	3-987-483-11	TAPE, BERODDED PREVENTION
IMB	A-6785-354-A	MANUAL BLOCK ASSY, INSTRUCTION

SCPH-30002 R F-type model ACCESSORIES & PACKING GROUP

Ref.	Part No.	Description
Δ AC	1-555-074-51	CORD, POWER
AV	1-792-028-11	AV CABLE (Integrated audio/video)
AV	1-792-028-21	AV CABLE (Integrated audio/video)
AV	1-792-028-31	AV CABLE (Integrated audio/video)
AV	1-792-028-41	AV CABLE (Integrated audio/video)
AV	1-792-028-51	AV CABLE (Integrated audio/video)
AV	1-792-028-61	AV CABLE (Integrated audio/video)
CONT	1-792-238-72	ANALOG CONTROLLER (DUALSHOCK 2)
CONT	1-823-069-11	ANALOG CONTROLLER (DUALSHOCK 2)
CONT	1-823-091-11	ANALOG CONTROLLER (DUALSHOCK 2)
CONT	1-823-552-11	ANALOG CONTROLLER (DUALSHOCK 2)
CU	3-064-714-01	CUSHION
SH	3-060-494-01	SHEET, PROTECTION
CA	3-071-639-01	INDIVIDUAL CARTON
PAD	3-065-172-01	PAD, TOGETHER PACKING
MC	3-071-635-52	MASTER CARTON, 3 SETS
TA	3-987-483-11	TAPE, BERODDED PREVENTION
IMB	A-6785-379-A	MANUAL BLOCK ASSY, INSTRUCTION

SCPH-30003 R F-type model ACCESSORIES & PACKING GROUP

Ref.	Part No.	Description
CONV	1-785-004-12	CONNECTOR, CONVERSION
CONV	1-573-291-12	CONNECTOR, CONVERSION
Δ AC	1-751-115-21	CORD, POWER
Δ AC	1-751-115-31	CORD, POWER
Δ AC	1-790-023-21	CODE, POWER
AV	1-792-028-11	AV CABLE (Integrated audio/video)
AV	1-792-028-21	AV CABLE (Integrated audio/video)
AV	1-792-028-31	AV CABLE (Integrated audio/video)
AV	1-792-028-41	AV CABLE (Integrated audio/video)
AV	1-792-028-51	AV CABLE (Integrated audio/video)
AV	1-792-028-61	AV CABLE (Integrated audio/video)
CONT	1-792-238-72	ANALOG CONTROLLER (DUALSHOCK 2)
CONT	1-823-069-11	ANALOG CONTROLLER (DUALSHOCK 2)
CONT	1-823-091-11	ANALOG CONTROLLER (DUALSHOCK 2)
CONT	1-823-552-11	ANALOG CONTROLLER (DUALSHOCK 2)
CU	3-064-714-01	CUSHION
SH	3-060-494-01	SHEET, PROTECTION
CA	3-071-634-11	INDIVIDUAL CARTON
PAD	3-065-172-01	PAD, TOGETHER PACKING
MC	3-071-635-42	MASTER CARTON, 3 SETS
TA	3-987-483-11	TAPE, BERODDED PREVENTION
IMB	A-6785-377-A	MANUAL BLOCK ASSY, INSTRUCTION

SCPH-30004 R F-type model ACCESSORIES & PACKING GROUP

Ref.	Part No.	Description
CONV	1-785-004-12	CONNECTOR, CONVERSION
CONV	1-573-291-12	CONNECTOR, CONVERSION
Δ AC	1-575-131-82	CORD, POWER
Δ AC	1-823-152-11	CORD, POWER
AV	1-792-028-11	AV CABLE (Integrated audio/video)
AV	1-792-028-21	AV CABLE (Integrated audio/video)
AV	1-792-028-31	AV CABLE (Integrated audio/video)
AV	1-792-028-41	AV CABLE (Integrated audio/video)
AV	1-792-028-51	AV CABLE (Integrated audio/video)
AV	1-792-028-61	AV CABLE (Integrated audio/video)
CONT	1-792-238-72	ANALOG CONTROLLER (DUALSHOCK 2)
CONT	1-823-069-11	ANALOG CONTROLLER (DUALSHOCK 2)
CONT	1-823-091-11	ANALOG CONTROLLER (DUALSHOCK 2)
CONT	1-823-552-11	ANALOG CONTROLLER (DUALSHOCK 2)
CU	3-064-714-01	CUSHION
SH	3-060-494-01	SHEET, PROTECTION
CA	3-071-634-02	INDIVIDUAL CARTON
PAD	3-065-172-01	PAD, TOGETHER PACKING
MC	3-071-635-32	MASTER CARTON, 3 SETS
TA	3-987-483-11	TAPE, BERODDED PREVENTION
IMB	A-6785-382-A	MANUAL BLOCK ASSY, INSTRUCTION

NOTE :

- Due to standardization, replacements in the parts list may be different from the parts specified in the diagrams or the components used on the set.
- -XX and -X mean standardized parts, so they may have some difference from the original one.
- RESISTORS
METAL : Metal-film resistor.
F : nonflammable
Unit is Ω.

- SEMICONDUCTORS
In each case, u : μ, for example :
uA .. : μA .. uPA .. : μPA ..
uPB .. : μPB .. uPC .. : μPC .. uPD .. : μPD ..
- CAPACITORS
uF : μF
- COILS
uH : μH

The components identified by mark Δ or dotted line with mark Δ are critical for safety. Replace only with part number specified.

SUPPLIED ACCESSORIES and PACKING GROUP

PLACE CODE #23

SCPH-30005 R F ACCESSORIES & PACKING GROUP

Ref.	Part No.	Description
Δ AC	1-823-638-11	CORD, POWER
AV	1-792-028-11	AV CABLE (Integrated audio/video)
AV	1-792-028-21	AV CABLE (Integrated audio/video)
AV	1-792-028-31	AV CABLE (Integrated audio/video)
AV	1-792-028-41	AV CABLE (Integrated audio/video)
AV	1-792-028-51	AV CABLE (Integrated audio/video)
AV	1-792-028-61	AV CABLE (Integrated audio/video)
CONT	1-792-238-72	ANALOG CONTROLLER (DUALSHOCK 2)
CONT	1-823-069-11	ANALOG CONTROLLER (DUALSHOCK 2)
CONT	1-823-091-11	ANALOG CONTROLLER (DUALSHOCK 2)
CONT	1-823-552-11	ANALOG CONTROLLER (DUALSHOCK 2)
CU	3-064-714-01	CUSHION
SH	3-060-494-01	SHEET, PROTECTION
CA	3-072-722-01	INDIVIDUAL CARTON
MC	3-072-723-01	MASTER CARTON, 3 SETS
IMB	A-6705-464-A	MANUAL BLOCK ASSY, INSTRUCTION

SCPH-30006 R F ACCESSORIES & PACKING GROUP

Ref.	Part No.	Description
Δ AC	1-823-738-11	CORD, POWER
AV	1-792-028-11	AV CABLE (Integrated audio/video)
AV	1-792-028-21	AV CABLE (Integrated audio/video)
AV	1-792-028-31	AV CABLE (Integrated audio/video)
AV	1-792-028-41	AV CABLE (Integrated audio/video)
AV	1-792-028-51	AV CABLE (Integrated audio/video)
AV	1-792-028-61	AV CABLE (Integrated audio/video)
CONT	1-792-238-72	ANALOG CONTROLLER (DUALSHOCK 2)
CONT	1-823-069-11	ANALOG CONTROLLER (DUALSHOCK 2)
CONT	1-823-091-11	ANALOG CONTROLLER (DUALSHOCK 2)
CONT	1-823-552-11	ANALOG CONTROLLER (DUALSHOCK 2)
CU	3-064-714-01	CUSHION
SH	3-060-494-01	SHEET, PROTECTION
CA	3-072-727-01	INDIVIDUAL CARTON
MC	3-072-728-01	MASTER CARTON, 3 SETS
IMB	A-6705-462-A	MANUAL BLOCK ASSY, INSTRUCTION

SCPH-30007 R F ACCESSORIES & PACKING GROUP

Ref.	Part No.	Description
Δ AC	1-757-562-61	CORD, POWER
AV	1-792-028-11	AV CABLE (Integrated audio/video)
AV	1-792-028-21	AV CABLE (Integrated audio/video)
AV	1-792-028-31	AV CABLE (Integrated audio/video)
AV	1-792-028-41	AV CABLE (Integrated audio/video)
AV	1-792-028-51	AV CABLE (Integrated audio/video)
AV	1-792-028-61	AV CABLE (Integrated audio/video)
CONT	1-792-238-72	ANALOG CONTROLLER (DUALSHOCK 2)
CONT	1-823-069-11	ANALOG CONTROLLER (DUALSHOCK 2)
CONT	1-823-091-11	ANALOG CONTROLLER (DUALSHOCK 2)
CONT	1-823-552-11	ANALOG CONTROLLER (DUALSHOCK 2)
CU	3-064-714-01	CUSHION
SH	3-060-494-01	SHEET, PROTECTION
CA	3-074-221-01	INDIVIDUAL CARTON
MC	3-074-220-01	MASTER CARTON, 3 SETS
IMB	A-6705-476-A	MANUAL BLOCK ASSY, INSTRUCTION

3. INSTRUCTION MANUAL BLOCK

NOTE :

- Due to standardization, replacements in the parts list may be different from the parts specified in the diagrams or the components used on the set.
- -XX and -X mean standardized parts, so they may have some difference from the original one.
- RESISTORS
METAL : Metal-film resistor.
F : nonflammable
Unit is Ω.

- SEMICONDUCTORS
In each case, u : μ, for example :
uA .. : μA .. uPA .. : μPA ..
uPB .. : μPB .. uPC .. : μPC .. uPD .. : μPD ..
- CAPACITORS
uF : μF
• COILS
uH : μH

The components identified by mark Δ or dotted line with mark Δ are critical for safety. Replace only with part number specified.

INSTRUCTION MANUAL BLOCK ASSY

PLACE CODE #23

**A-6785-354-A INSTRUCTION MANUAL BLOCK ASSY
for SCPH-30001 R (F-type)**

Ref.	Part No.	Description
CI	3-072-824-01	CARD, CUSTOMER INQUIRY
CS	3-066-966-01	CARD, SERVICE NUMBER
ES	3-060-161-02	SHEET, ESRE
IM	3-071-581-13	MANUAL, INSTRUCTION

**A-6785-377-A INSTRUCTION MANUAL BLOCK ASSY
for SCPH-30003 R (F-type)**

Ref.	Part No.	Description
BOR	3-066-159-02	CARD (B), OWNER REGISTRATION
DISK	3-073-543-01	DISK, DEMONSTRATION
IM	3-071-581-33	MANUAL, INSTRUCTION
SE	3-987-375-02	SEAL, SEAL

**A-6705-464-A INSTRUCTION MANUAL BLOCK ASSY
for SCPH-30005 R (F type)**

Ref.	Part No.	Description
IM	3-071-581-61	MANUAL, INSTRUCTION

**A-6705-476-A INSTRUCTION MANUAL BLOCK ASSY
for SCPH-30007 R (F-type)**

Ref.	Part No.	Description
IM	3-071-581-__	MANUAL, INSTRUCTION

**A-6785-379-A INSTRUCTION MANUAL BLOCK ASSY
for SCPH-30002 R (F-type)**

Ref.	Part No.	Description
AOR	3-066-158-02	CARD (A), OWNER REGISTRATION
DISK	3-073-543-01	DISK, DEMONSTRATION
IM	3-071-581-22	MANUAL, INSTRUCTION
SE	3-987-375-02	SEAL, SEAL

**A-6785-382-A INSTRUCTION MANUAL BLOCK ASSY
for SCPH-30004 R (F-type)**

Ref.	Part No.	Description
COR	3-066-160-03	CARD (C), OWNER REGISTRATION
DISK	3-073-543-01	DISK, DEMONSTRATION
IM	3-071-581-43	MANUAL, INSTRUCTION
IM	3-071-581-53	MANUAL, INSTRUCTION
SE	3-987-375-02	SEAL, SEAL

**A-6705-462-A INSTRUCTION MANUAL BLOCK ASSY
for SCPH-30006 R (F-type)**

Ref.	Part No.	Description
IM	3-071-581-71	MANUAL, INSTRUCTION

4. EXPLODED VIEWS

Overall and Main Block for SCPH-30001 R(UC2)

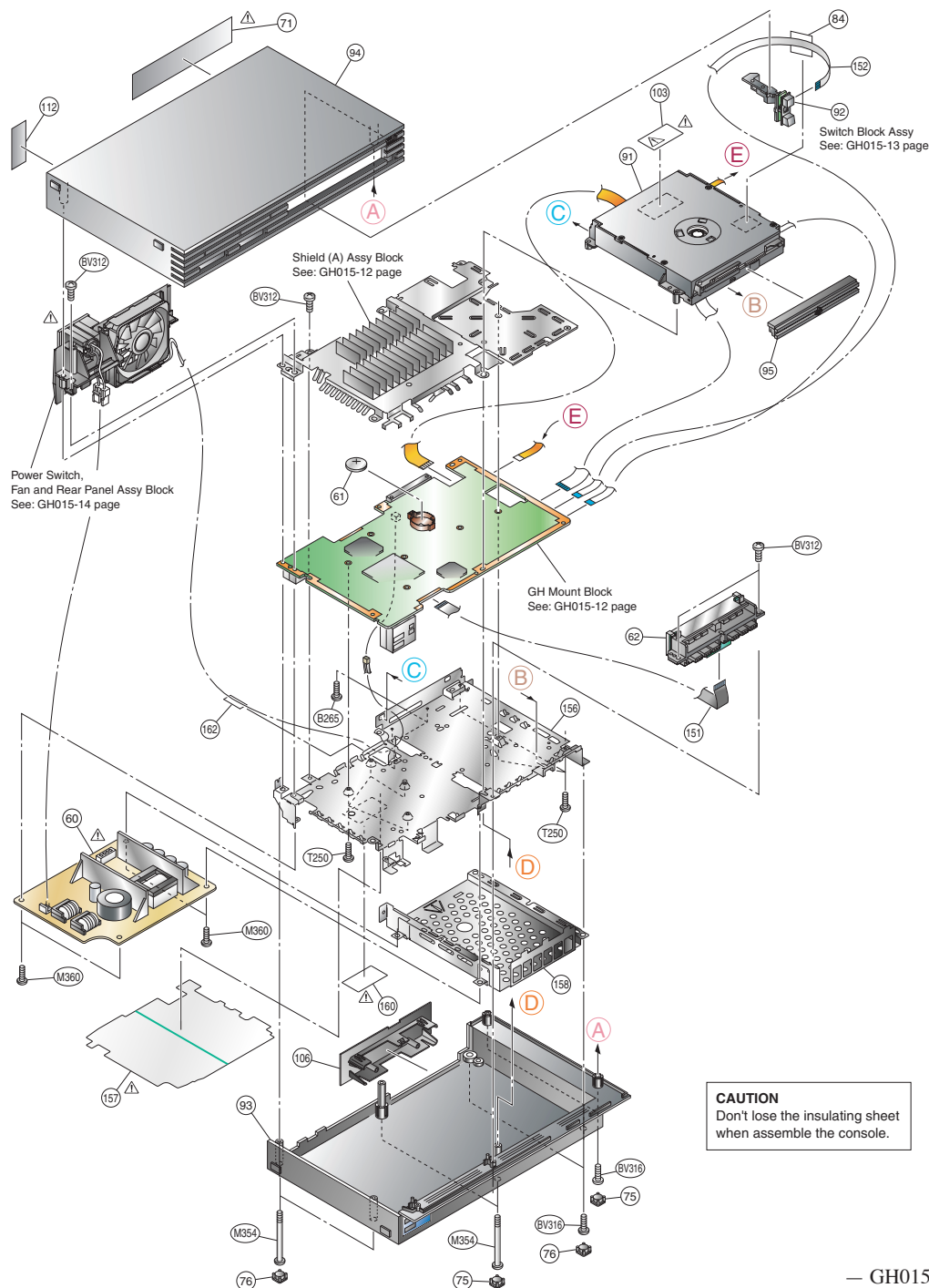

CAUTION

The components identified by mark Δ or dotted line with mark Δ are critical for safety. Replace only with part number specified.

CAUTION :
Use of controls or adjustments or performance of procedures other than those specified herein may result in hazardous radiation exposure.

OVERALL AND MAIN BLOCK

Ref-No.	Part No.	Description	Remark	Place code
Δ 60	1-468-604-11	POWER BLOCK	for 120V AC	#00
Δ 60	1-468-623-11	POWER BLOCK	for 120V AC	#00
61	1-528-174-41	BATTERY, LITHIUM (CR2032 TYPE)		#25GH
62	1-694-873-11	TERMINAL BOARD (FRONT)		#17
62	1-694-874-11	TERMINAL BOARD (FRONT)		#17
62	1-694-875-11	TERMINAL BOARD (FRONT)		#17
Δ 71	3-071-967-01	LABEL, MODEL NUMBER (UC2)		#87
75	3-059-626-03	COVER, SCREW		#22
76	3-059-627-01	CAP		#22
84	3-067-170-01	TAPE (20X20), HARNESS STOPPER		#87
91	A-6705-440-A	MD BLOCK ASSY		#10
92	A-6705-439-A	SWITCH BLOCK ASSY		#87
93	X-3951-706-2	COVER ASSY, LOWER		#87
94	X-3951-705-2	COVER ASSY, UPPER		#87
95	X-3951-099-1	PLATE ASSY, ORNAMENTAL		#87
Δ 103	3-976-231-11	LABEL, CAUTION		#87
106	3-070-847-01	LID		#87
112	3-066-253-01	TAPE, VOID		#87
151	1-757-934-11	CABLE, FLEXIBLE FLAT (FFC-011)		#12
151	1-757-934-21	CABLE, FLEXIBLE FLAT (FFC-011)		#12
151	1-757-934-31	CABLE, FLEXIBLE FLAT (FFC-011)		#12
152	1-823-341-11	CABLE, FLEXIBLE FLAT (FFC-015)		#12
152	1-823-341-21	CABLE, FLEXIBLE FLAT (FFC-015)		#12
156	3-071-970-02	SHIELD B (F)		#16
Δ 157	3-071-971-01	SHEET, INSULATING		#16
158	3-071-973-01	SHIELD HDD (F)		#87
Δ 160	3-703-692-01	LABEL, CAUTION, BARRIER		#16
162	3-069-212-01	TAPE, HARNESS STOPPER		#87
B265	3-069-170-01	TAPPING (B2X6.5)		#87
BV312	3-325-679-21	SCREW, TAPPING +BV 3X12		#87
BV316	3-070-296-01	TAPPING +BV 3X16		#87
BV316	3-325-679-91	SCREW (2 LOCK), +BV TAPPING		#87
M354	3-059-622-02	SCREW (M3X54), HEAD TAPPING		#87
M360	3-069-168-01	TITE (CZN), M3X6 +BV S		#87
T250	3-071-976-01	TAPPING (2X5)		#87

CAUTION
Don't lose the insulating sheet when assemble the console.

Overall and Main Block for SCPH-30002 R(AU3) /-30003 R(CEK) /-30004 R(CEL)

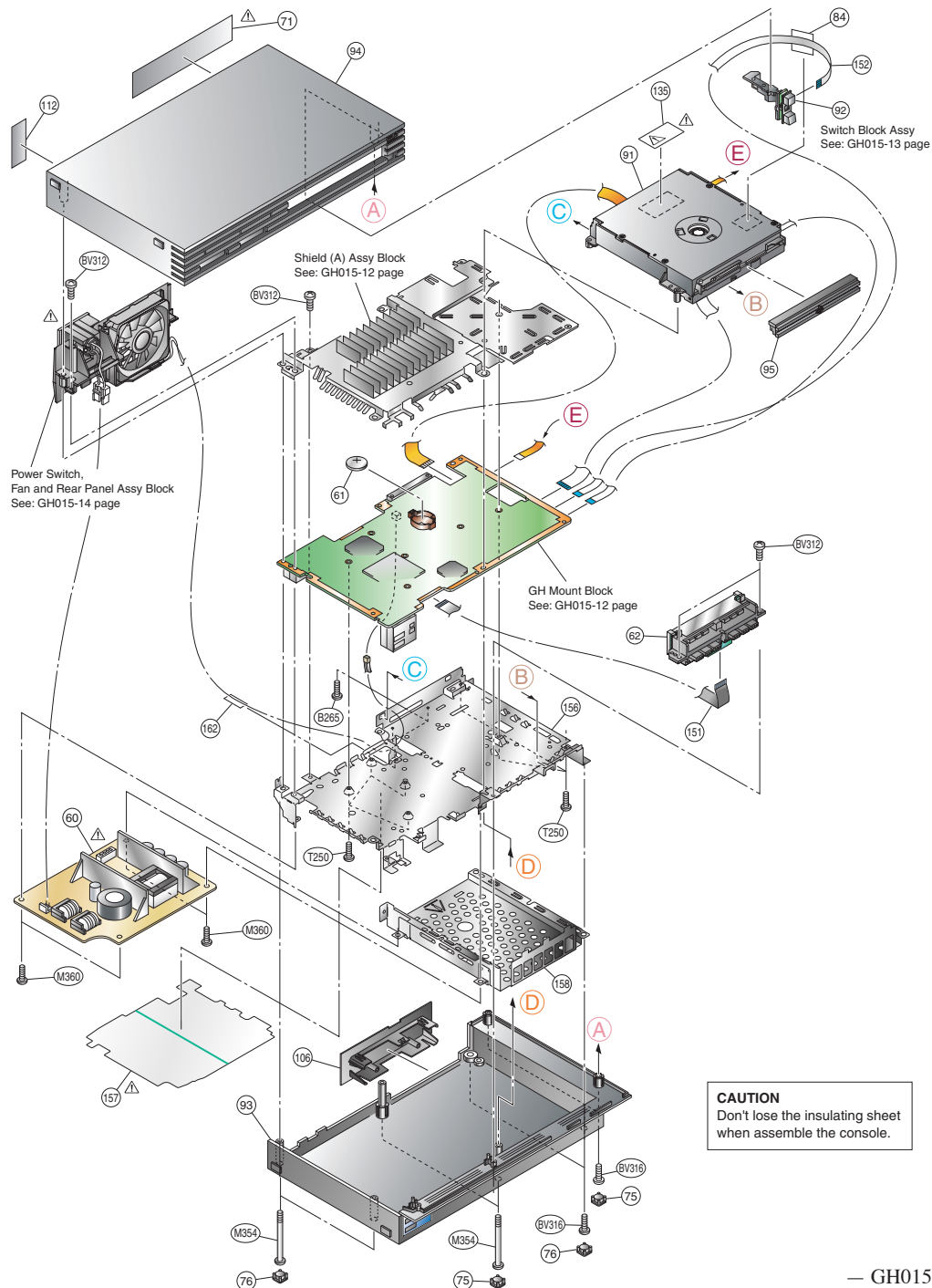

CAUTION

The components identified by mark Δ or dotted line with mark Δ are critical for safety. Replace only with part number specified.

CAUTION :
Use of controls or adjustments or performance of procedures other than those specified herein may result in hazardous radiation exposure.

OVERALL AND MAIN BLOCK

Ref-No.	Part No.	Description	Remark	Place code
Δ 60	1-468-605-11	POWER BLOCK	for 220-240V AC	#00
Δ 60	1-468-605-21	POWER BLOCK	for 220-240V AC	#00
Δ 61	1-528-174-41	BATTERY, LITHIUM (CR2032 TYPE)		#25GH
62	1-694-873-11	TERMINAL BOARD (FRONT)		#17
62	1-694-874-11	TERMINAL BOARD (FRONT)		#17
62	1-694-875-11	TERMINAL BOARD (FRONT)		#17
Δ 71	3-072-419-01	LABEL, MODEL NUMBER (AU3)	for SCPH-30002 R F	#87
Δ 71	3-072-418-01	LABEL, MODEL NUMBER (CEK)	for SCPH-30003 R F	#87
Δ 71	3-072-417-01	LABEL, MODEL NUMBER (CEL)	for SCPH-30004 R F	#87
75	3-059-626-03	COVER, SCREW		#22
76	3-059-627-01	CAP		#22
84	3-067-170-01	TAPE (20X20), HARNESS STOPPER		#87
91	A-6705-440-A	MD BLOCK ASSY		#10
92	A-6705-439-A	SWITCH BLOCK ASSY		#87
93	X-3951-722-2	COVER ASSY, LOWER		#87
94	X-3951-721-2	COVER ASSY, UPPER		#87
95	X-3951-099-1	PLATE ASSY, ORNAMENTAL		#87
106	3-070-847-11	LID		#87
112	3-066-498-01	TAPE, VOID		#87
Δ 135	3-988-711-02	LABEL, LASER CAUTION		#87
151	1-757-934-11	CABLE, FLEXIBLE FLAT (FFC-011)		#12
151	1-757-934-21	CABLE, FLEXIBLE FLAT (FFC-011)		#12
151	1-757-934-31	CABLE, FLEXIBLE FLAT (FFC-011)		#12
152	1-823-341-11	CABLE, FLEXIBLE FLAT (FFC-015)		#12
152	1-823-341-21	CABLE, FLEXIBLE FLAT (FFC-015)		#12
156	3-071-970-02	SHIELD B (F)		#16
Δ 157	3-071-971-01	SHEET, INSULATING		#16
158	3-071-973-01	SHIELD HDD (F)		#87
162	3-069-212-01	TAPE, HARNESS STOPPER		#87
B265	3-069-170-01	TAPPING (B2X6.5)		#87
BV312	3-325-679-21	SCREW, TAPPING +BV 3X12		#87
BV316	3-070-296-01	TAPPING +BV 3X16		#87
BV316	3-325-679-91	SCREW (2 LOCK), +BV TAPPING		#87
M354	3-059-622-02	SCREW (M3X54), HEAD TAPPING		#87
M360	3-069-168-01	TITE (CZN), M3X6 +BV S		#87
T250	3-071-976-01	TAPPING (2X5)		#87

Overall and Main Block for SCPH-30005 R(KR2) /-30006 R(E12) /-30007 R(TW1)

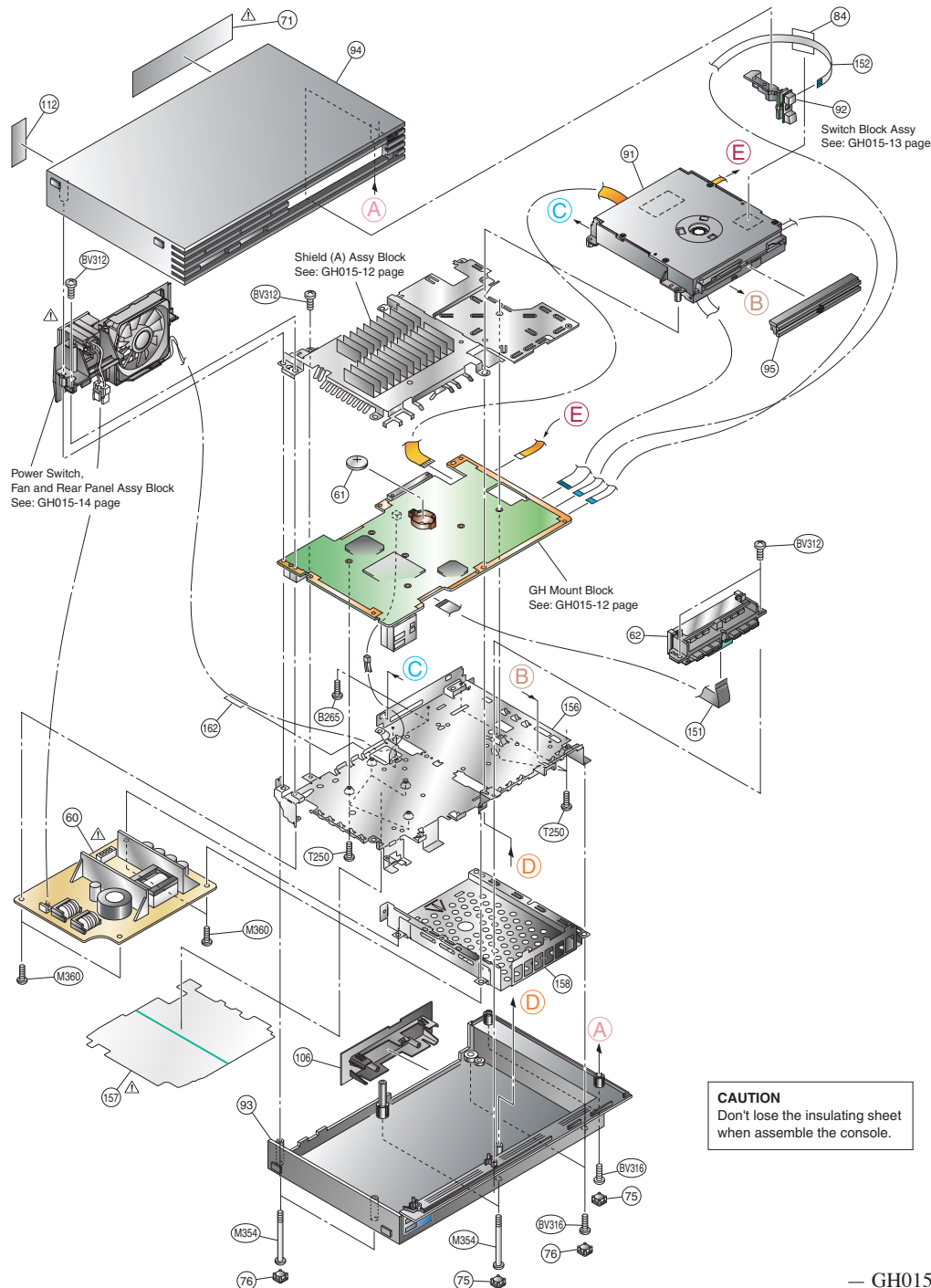

CAUTION

The components identified by mark Δ or dotted line with mark Δ are critical for safety. Replace only with part number specified.

CAUTION :
Use of controls or adjustments or performance of procedures other than those specified herein may result in hazardous radiation exposure.

OVERALL AND MAIN BLOCK

Ref-No.	Part No.	Description	Remark	Place code
Δ 60	1-468-605-11	POWER BLOCK	for SCPH-30005 R /-30006 R	#00
Δ 60	1-468-605-21	POWER BLOCK	for SCPH-30005 R /-30006 R	#00
Δ 60	1-468-670-11	POWER BLOCK	for SCPH-30007 R	#00
61	1-528-174-41	BATTERY, LITHIUM (CR2032 TYPE)		#25GH
62	1-694-873-11	TERMINAL BOARD (FRONT)		#17
62	1-694-874-11	TERMINAL BOARD (FRONT)		#17
Δ 71	3-072-581-01	LABEL, MODEL NUMBER (KR2)	for SCPH-30005 R	#87
Δ 71	3-072-582-01	LABEL, MODEL NUMBER (E12)	for SCPH-30006 R	#87
Δ 71	3-073-958-01	LABEL, MODEL NUMBER (TW1)	for SCPH-30007 R	#87
75	3-059-626-03	COVER, SCREW		#22
76	3-059-627-01	CAP		#22
84	3-067-170-01	TAPE (20X20), HARNESS STOPPER		#87
91	A-6705-440-A	MD BLOCK ASSY		#10
92	A-6705-439-A	SWITCH BLOCK ASSY		#87
93	X-3951-706-2	COVER ASSY, LOWER	for SCPH-30005 R	#87
93	X-3951-722-2	COVER ASSY, LOWER	for SCPH-30006 R /-30007 R	#87
94	X-3951-705-2	COVER ASSY, UPPER	for SCPH-30005 R	#87
94	X-3951-721-2	COVER ASSY, UPPER	for SCPH-30006 R /-30007 R	#87
95	X-3951-099-1	PLATE ASSY, ORNAMENTAL		#87
106	3-070-847-11	LID		#87
112	3-073-722-01	VOID TAPE (E12)	for SCPH-30006 R /-30007 R	#87
112	3-073-723-01	VOID TAPE (KR2)	for SCPH-30005 R	#87
151	1-757-934-11	CABLE, FLEXIBLE FLAT (FFC-011)		#12
151	1-757-934-21	CABLE, FLEXIBLE FLAT (FFC-011)		#12
151	1-757-934-31	CABLE, FLEXIBLE FLAT (FFC-011)		#12
152	1-823-341-11	CABLE, FLEXIBLE FLAT (FFC-015)		#12
152	1-823-341-21	CABLE, FLEXIBLE FLAT (FFC-015)		#12
156	3-071-970-02	SHIELD B (F)		#16
Δ 157	3-071-971-01	SHEET, INSULATING		#16
158	3-071-973-01	SHIELD HDD (F)		#87
162	3-069-212-01	TAPE, HARNESS STOPPER		#87
B265	3-069-170-01	TAPPING (B2X6.5)		#87
BV312	3-325-679-21	SCREW, TAPPING +BV 3X12		#87
BV316	3-059-622-02	SCREW (2 LOCK), +BV TAPPING		#87
M354	3-325-679-91	SCREW (M3X54), HEAD TAPPING		#87
M360	3-069-168-01	TITE (CZN), M3X6 +BV S		#87
T250	3-071-976-01	TAPPING (2X5)		#87

MD Block

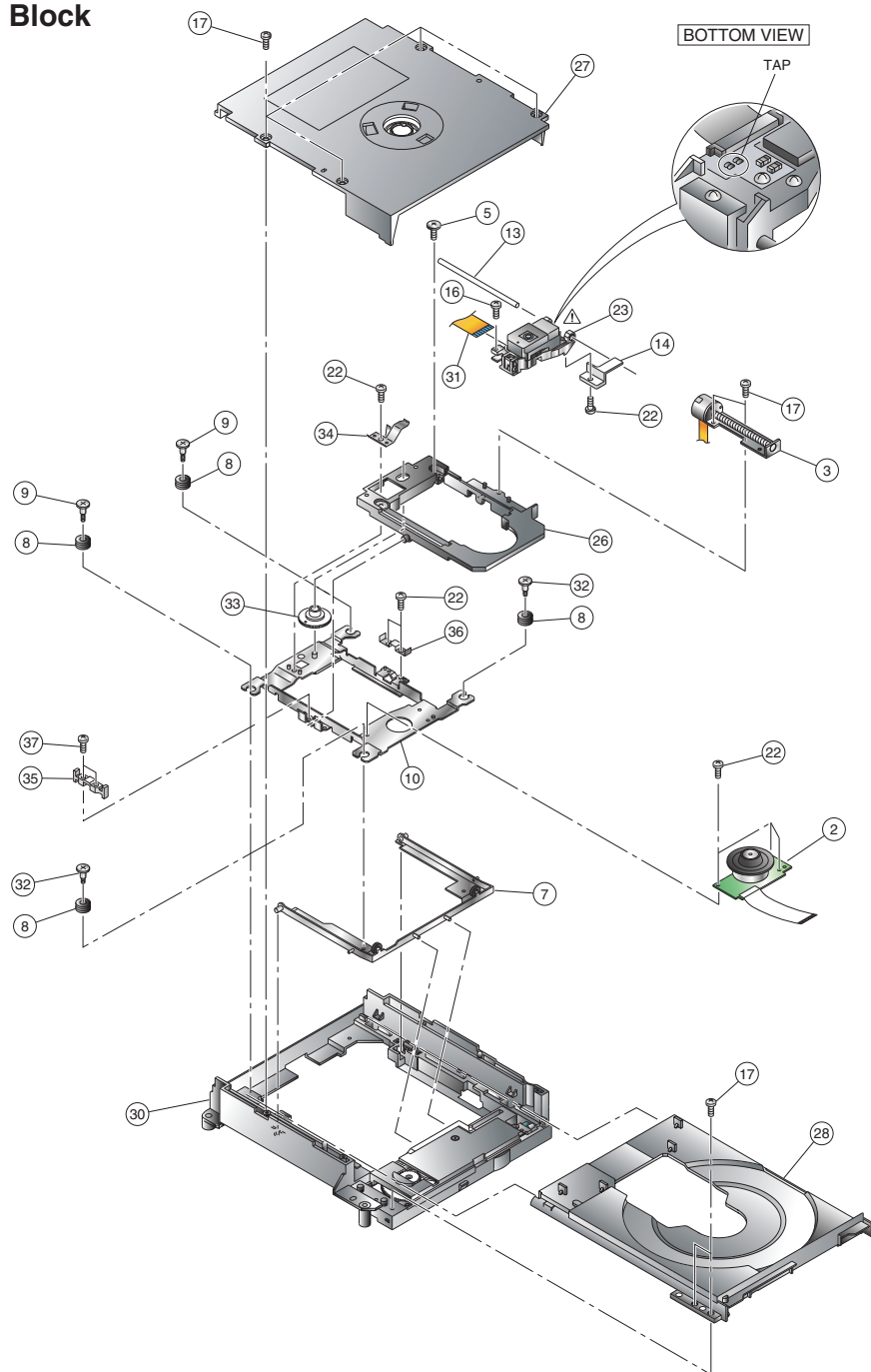

CAUTION

The components identified by mark Δ or dotted line with mark Δ are critical for safety. Replace only with part number specified.

CAUTION : Use of controls or adjustments or performance of procedures other than those specified herein may result in hazardous radiation exposure.

MD BLOCK

Ref.No.	Part No.	Description	Remark	Place code
2	1-763-700-21	MOTOR, DC (SPINDLE)		#10SP
2	8-835-733-03	MOTOR, DC SSC28C/C-NP		#10SP
3	1-763-639-21	MOTOR, DC (SLED)		#10
5	3-059-845-01	SCREW (B2X6.5), SHAFT RETAINER		#10
7	X-3951-637-1	FRAME ASSY, SUB		#10
8	3-065-277-01	INSULATOR		#10
9	3-065-276-01	SCREW, STEP		#10
10	3-071-957-01	CHASSIS, MAIN		#10
13	3-059-854-02	SHAFT, MAIN		#10
14	3-059-855-02	RACK		#10
16	3-060-399-01	SCREW, SKEW		#10
17	3-060-400-01	TAPPING (B2X6.5)		#10
22	3-062-728-01	0 PLATE 3 MAIN M2X3.2		#10
Δ 23	1-758-717-11	DEVICE, OPTICAL SF-HD7	Made by Sanyo(Not supply)	#10OP
Δ 23	8-820-151-01	DEVICE, OPTICAL KHS-400C	Made by Sony	#10OP
26	X-3952-057-1	CHASSIS ASSY, SUB		#10
27	X-3952-059-1	BRACKET ASSY, PULLEY		#10
28	X-3952-060-1	TRAY ASSY		#10TR
30	X-3952-058-1	FRAME ASSY, MAIN		#10
31	1-680-370-21	PWB, FLEXIBLE		#10
32	3-068-075-02	SCREW (SUB), STEP		#10
33	3-071-965-01	CAM, TILT		#10
34	3-071-966-01	SPRING (TILT), LEAF		#10
35	3-065-282-01	GUIDE (L)		#10
36	3-065-283-01	GUIDE (R)		#10
37	3-065-557-01	SCREW (M2X6.0)		#10

CAUTION : EEPROM DATA is different between optical device made by Sony and made by Sanyo.
EEPROM DATA have to rewrite BASED ON replacing OPTICAL DEVICE.

GH Mount Block

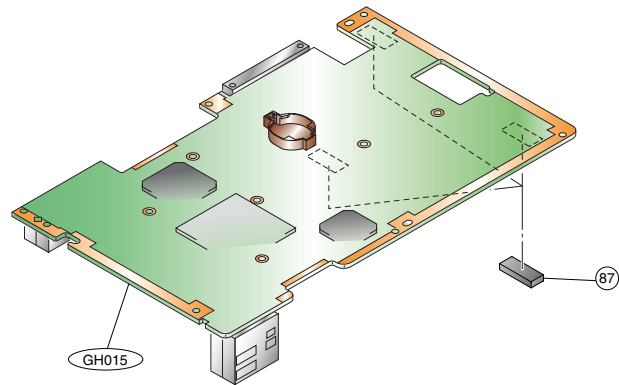

Shield (A) Assy Block

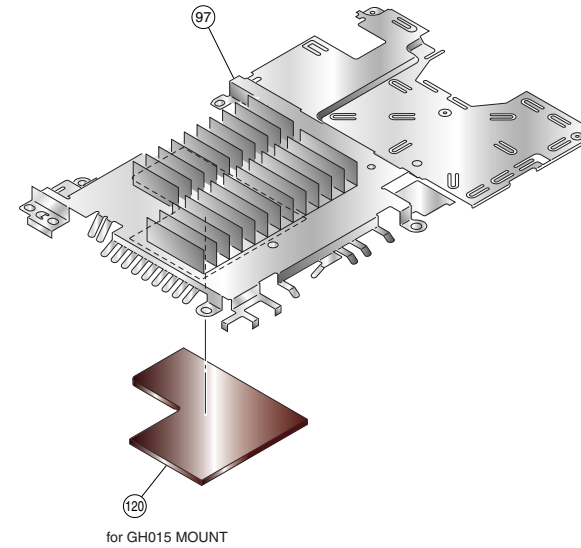

GH MOUNT BLOCK

Ref-No.	Part No.	Description	Remark	Place code
87	3-068-806-02	SHEET (DRIVER), ELECTRIC HEAT		#87
GH015	A-6714-501-A	GH-015 MOUNT	for SCPH-30001 R	#25GH
GH015	A-6714-504-A	GH-015 MOUNT	for SCPH-30002 R	#25GH
GH015	A-6714-505-A	GH-015 MOUNT	for SCPH-30003 R /-30004 R	#25GH
GH015	A-6714-514-A	GH-015 MOUNT	for SCPH-30005 R	#25GH
GH015	A-6714-513-A	GH-015 MOUNT	for SCPH-30006 R	#25GH
GH015	A-6714-520-A	GH-015 MOUNT	for SCPH-30007 R	#25GH

SHIELD (A) ASSY BLOCK

Ref-No.	Part No.	Description	Remark	Place code
97	X-3952-061-1	SHIELD A (F) ASSY		#87
120	3-059-652-01	SHEET (A), ELECTRIC HEAT		#87

Switch Assy Block

SWITCH ASSY BLOCK

A-6705-439-A SW-367 SWITCH ASSY BLOCK for GH015 MOUNT

<u>Ref-No.</u>	<u>Part No.</u>	<u>Description</u>	<u>Remark</u>	<u>Place code</u>
50	3-059-665-03	BUTTON, SWITCH		#25SW
51	3-059-666-05	BRACKET, SWITCH		#25SW
51	3-066-494-01	BRACKET, SWITCH		#25SW
52	7-685-105-11	TPG +P 2X8, TYPE 2, NON-SLIT		#25SW
53	A-6714-500-A	SW-367 MOUNT		#25SW

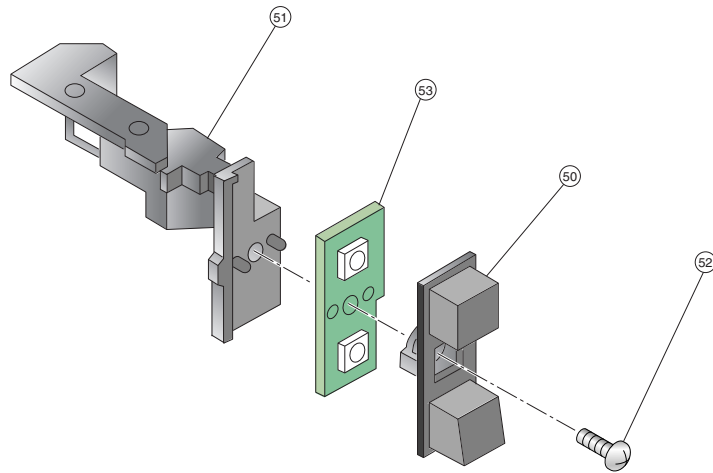

CAUTION

The components identified by mark \triangle or dotted line with mark \triangle are critical for safety. Replace only with part number specified.

CAUTION :
Use of controls or adjustments or performance of procedures other than those specified herein may result in hazardous radiation exposure.

Power Switch, Fan and Rear Panel Assy Block

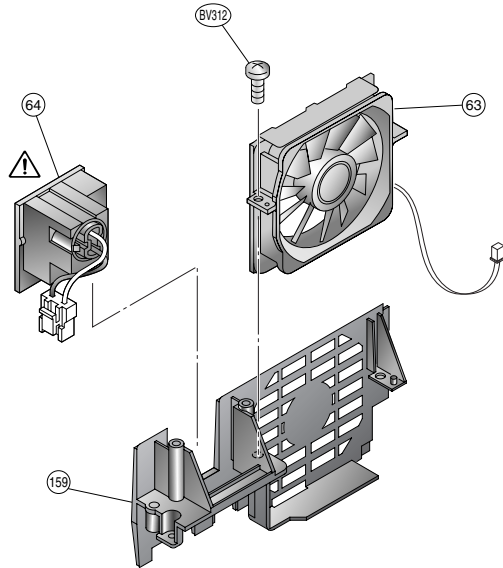

Ref-No.	Part No.	Description	Remark	Place code
63	1-763-480-31	DC. FAN		#74
63	1-763-554-31	FAN, DC		#74
63	1-763-756-21	FAN, D.C.		#74
\triangle 64	1-771-994-31	SWITCH, POWER (WITH AC INLET)	for SCPH-30001 R / -30005 R	#00
\triangle 64	1-786-209-21	SWITCH, POWER (WITH AC INLET)	for SCPH-30002 R / -30003 R / -30004 R SCPH-30006 R / -30007 R	#00
159	3-071-901-01	PANEL, REAR	for SCPH-30001 R / -30005 R	#87
159	3-071-901-11	PANEL, REAR	for SCPH-30002 R / -30003 R / -30004 R SCPH-30006 R / -30007 R	#87
BV312	3-325-679-21	SCREW, TAPPING +BV 3X12		#87

5. BLOCK DIAGRAM

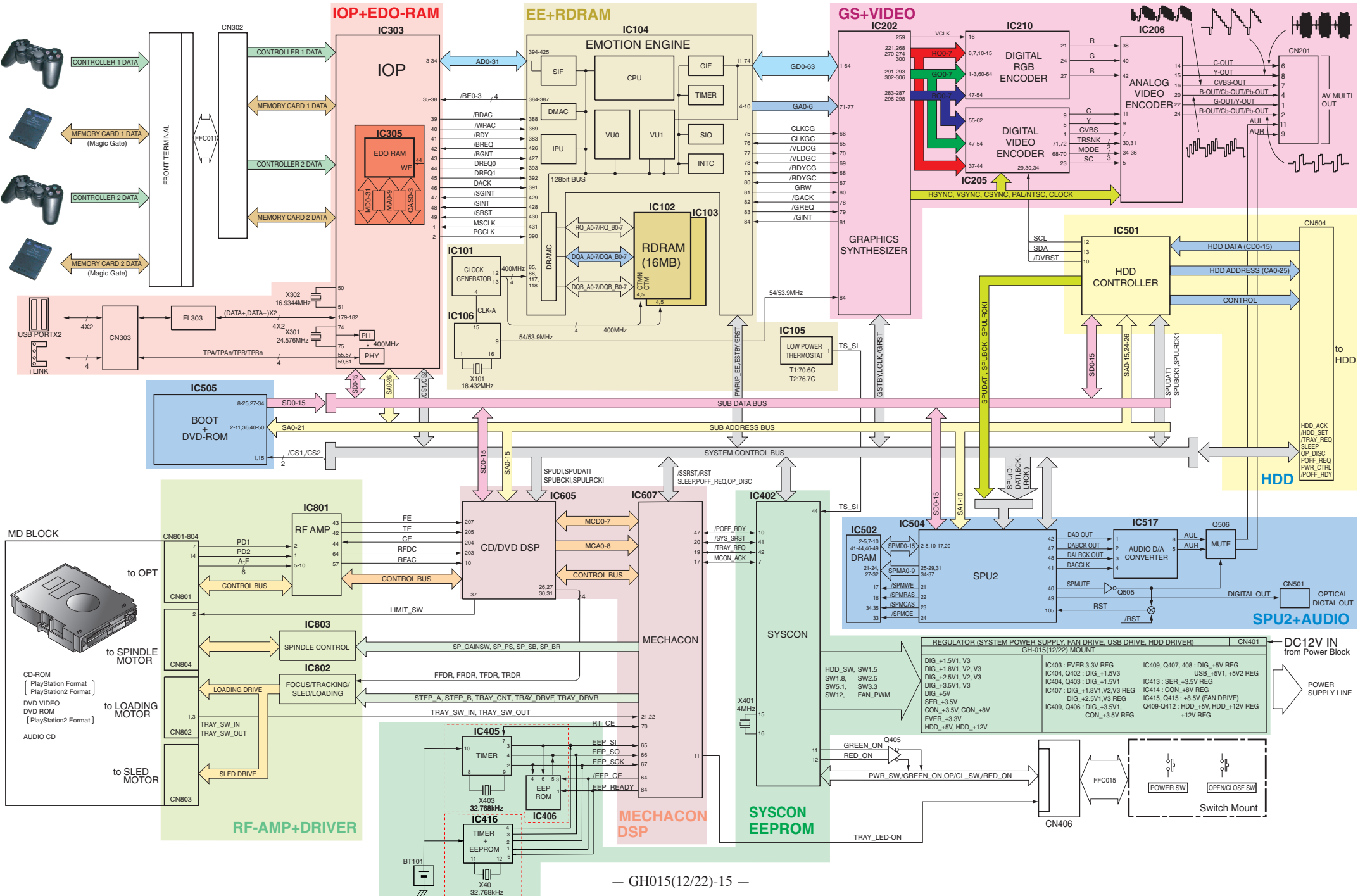

6. PRINTED WIRING BOARDS AND SCHEMATIC DIAGRAMS for GH015(12/22) MOUNT

THIS NOTE IS COMMON FOR PRINTED WIRING BOARDS AND SCHEMATIC DIAGRAMS.



Note on Printed Wiring Boards :

- Through hole is omitted.
-  : Pattern on the side which is seen.

Note on Schematic Diagram :

- Use caution when replacing chip parts.
New parts must be attached after removal of chip.
Be careful not to heat the minus side of tantalum capacitor, because it is damaged by the heat.
- All capacitors are in F unless otherwise noted. pF : F 50 WV or less are not indicated except for electrolytics and tantalums.
- All resistors are in Ω and 1/4 W (Chip resistors : 1/10W) unless otherwise specified.
- Chip resistors are 1/8 W or 1/10 W unless otherwise noted.
k Ω : 1000 Ω , M Ω : 1000 k Ω .

Note :













The components identified by mark  or dotted line with mark  are critical for safety. Replace only with part number specified.

Note :

Les composants identifies par une marque  sont critiques pour la securite. Ne les remplacer que par une piece portant le numero specifie.

Note on DC Power line :

Unit of voltage is V (volt)

- | | |
|---|---|
| • +12V :  | • +3.3V :  |
| • +8.0V :  | • +2.5V :  |
| • +5.0V :  | • +1.8V :  |
| • +3.5V :  | • VC :  |
| • +1.7V :  | • +1.5V :  |
-
- | | |
|---|--|
| • IN :  | • Main Signal Line :  |
| • OUT :  | |

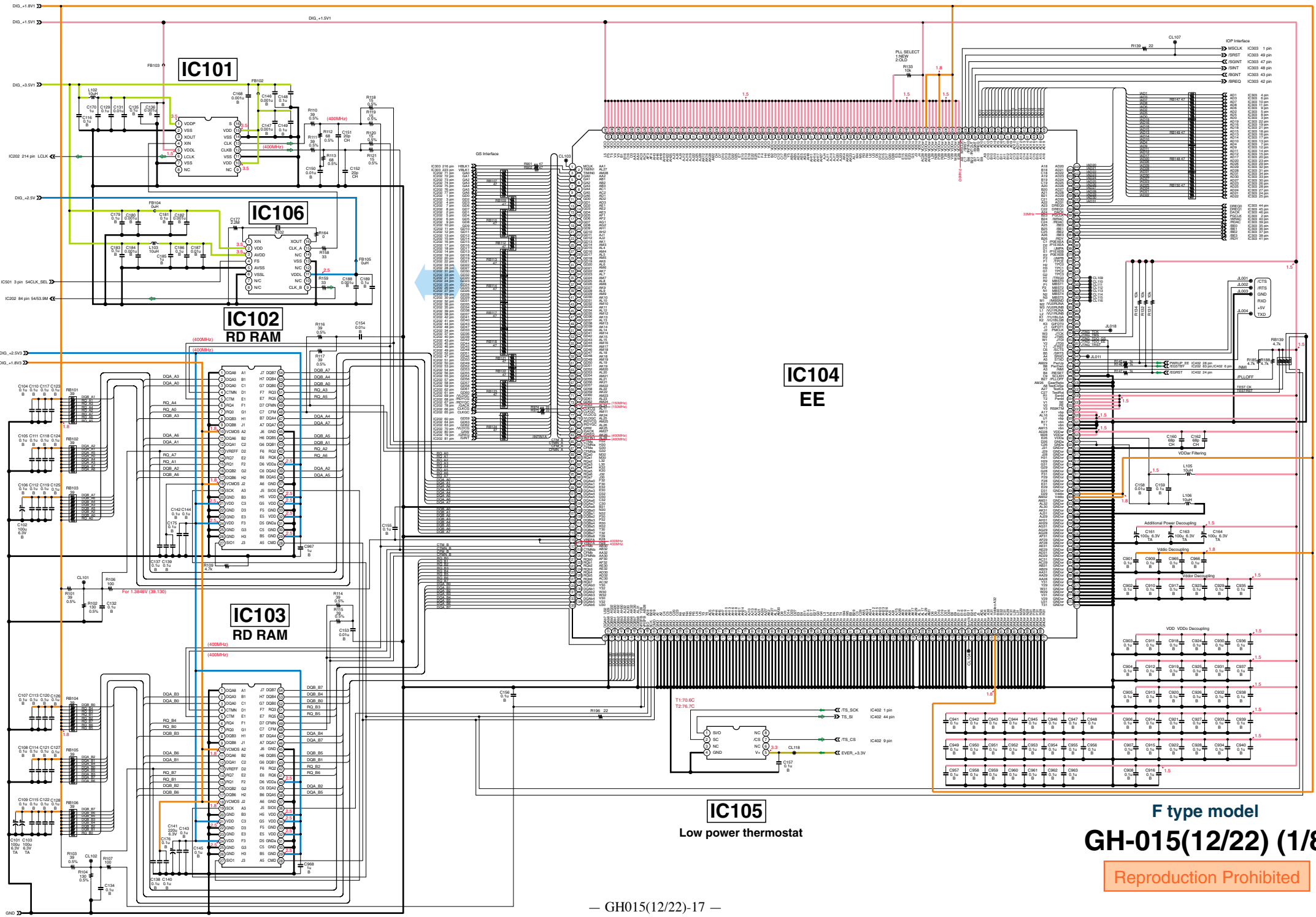

F type model
GH-015(12/22) (1/8)

Reproduction Prohibited

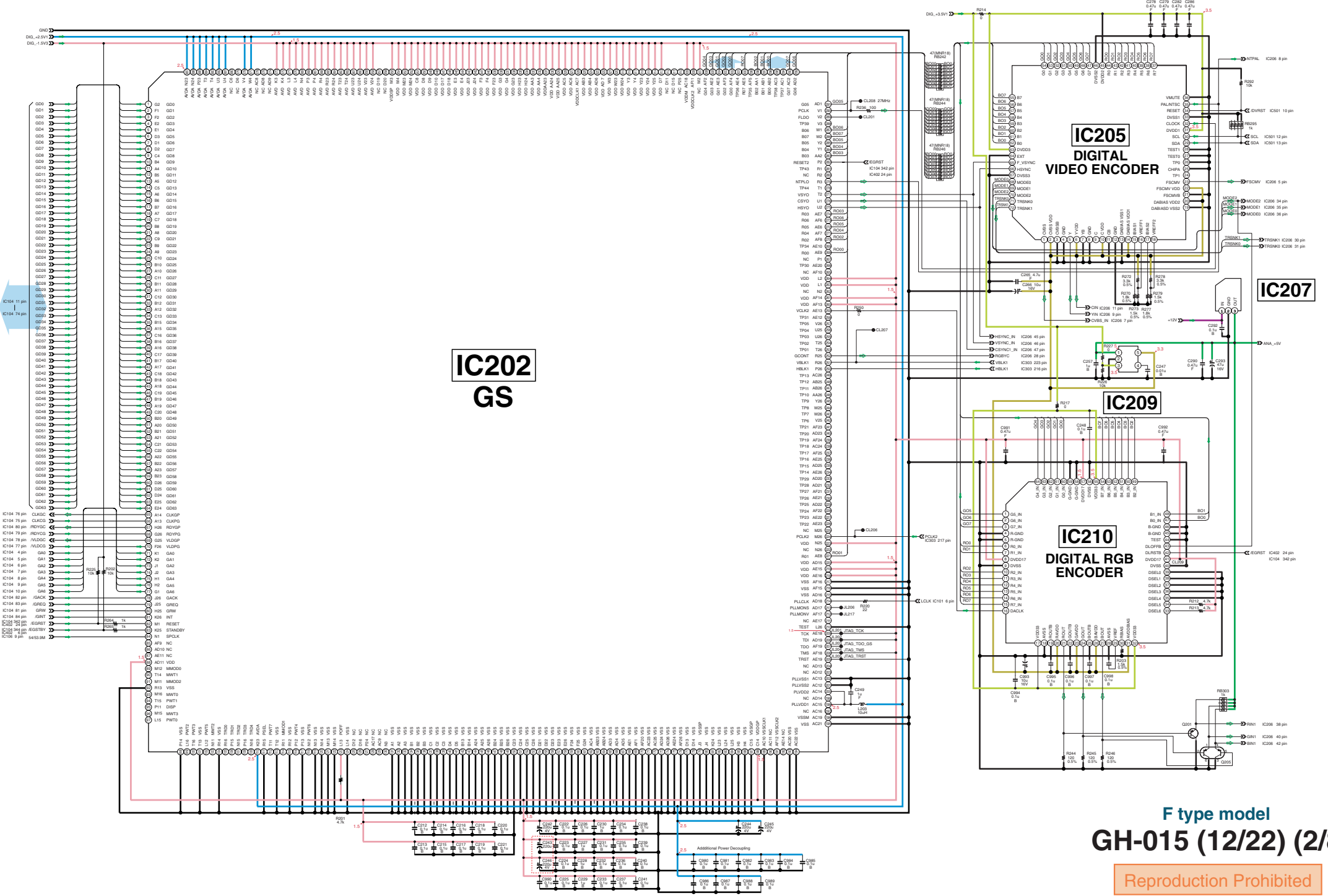

IC202
GS

IC205
DIGITAL
VIDEO ENCODER

IC209

IC210
DIGITAL RGB
ENCODER

IC207

F type model
GH-015 (12/22) (2/8)

Reproduction Prohibited

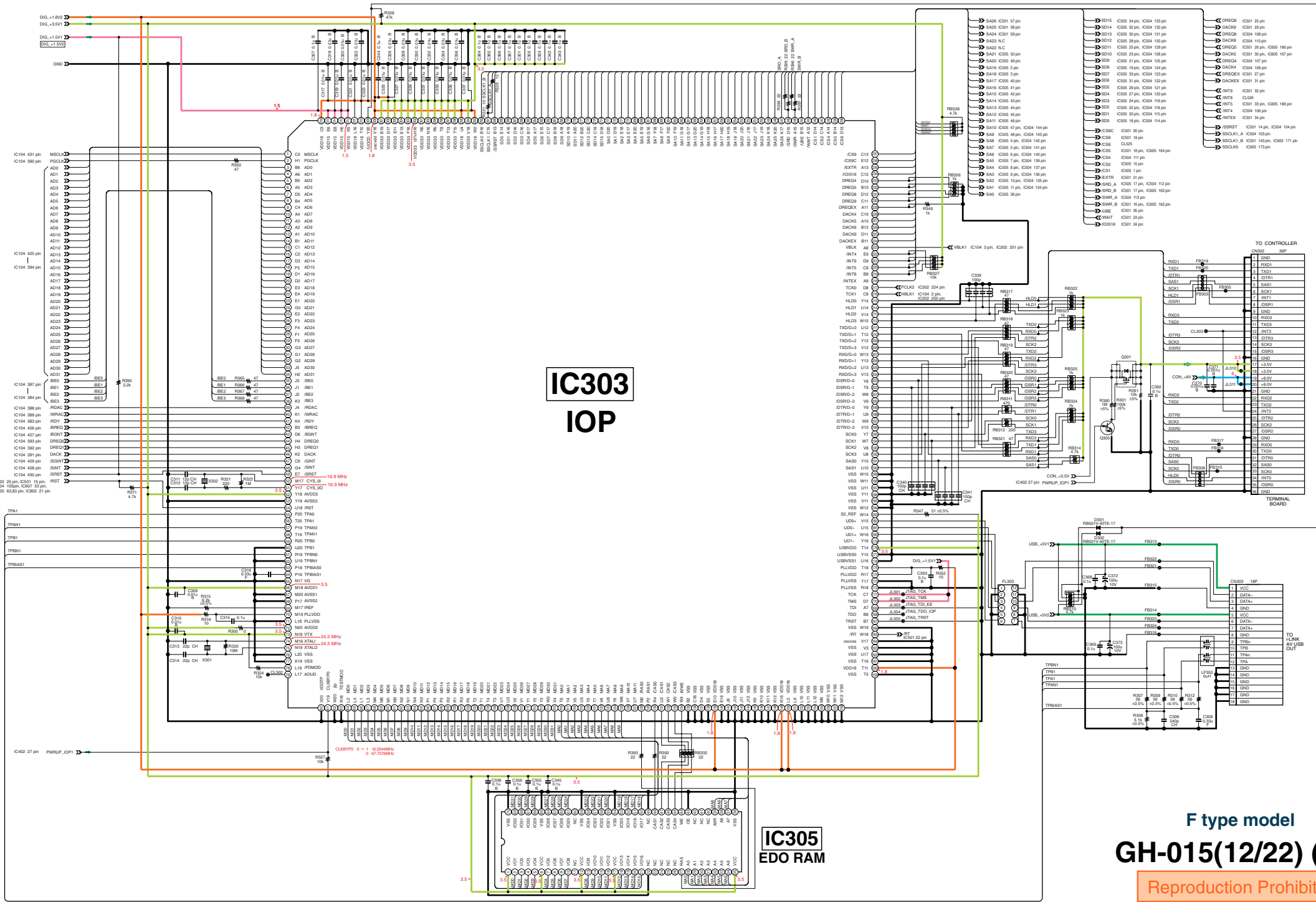

IC303 IOP

IC305 EDO RAM

F type model GH-015(12/22) (3/8)

Reproduction Prohibited

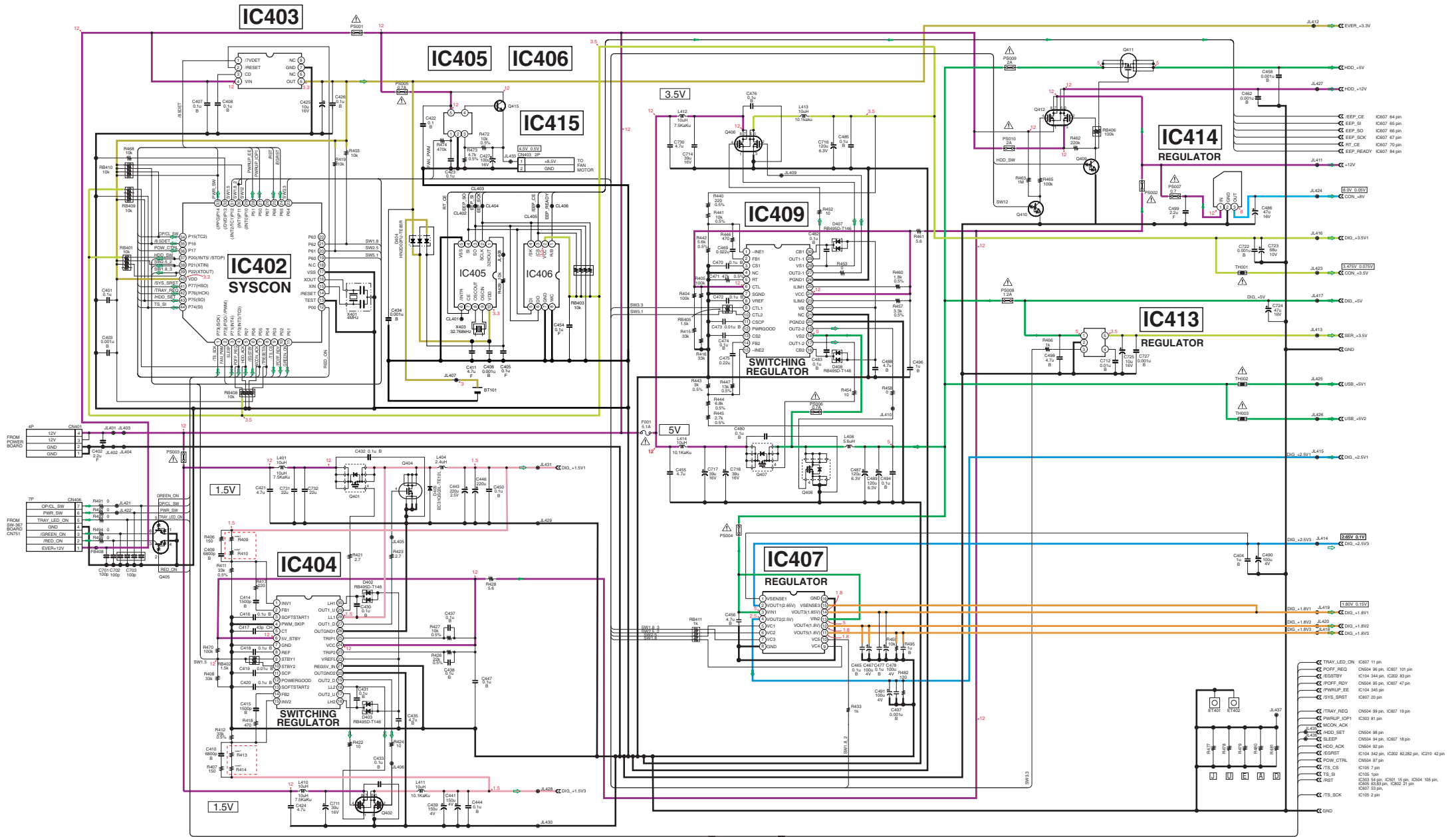

note1

	R409 & R414	R410 & R413
When C243 is mounted	: 0 ohm	33K ohm 0.5%
When C243 is not mounted	: 2.2K ohm	30K ohm 0.5%

F type model
GH-015(12/22)-1 (4/8)

Registration Prohibited

IC607 type used for this circuit.

CXP103049-401GG-TL for SCPH-30005 R/30006 R/30007 R

CXP103049-102GG-TL for SCPH-30001 R

CXP103049-302GG-TL for SCPH-30002 R

CXP103049-202GG-TL for SCPH-30003 R/30004 R

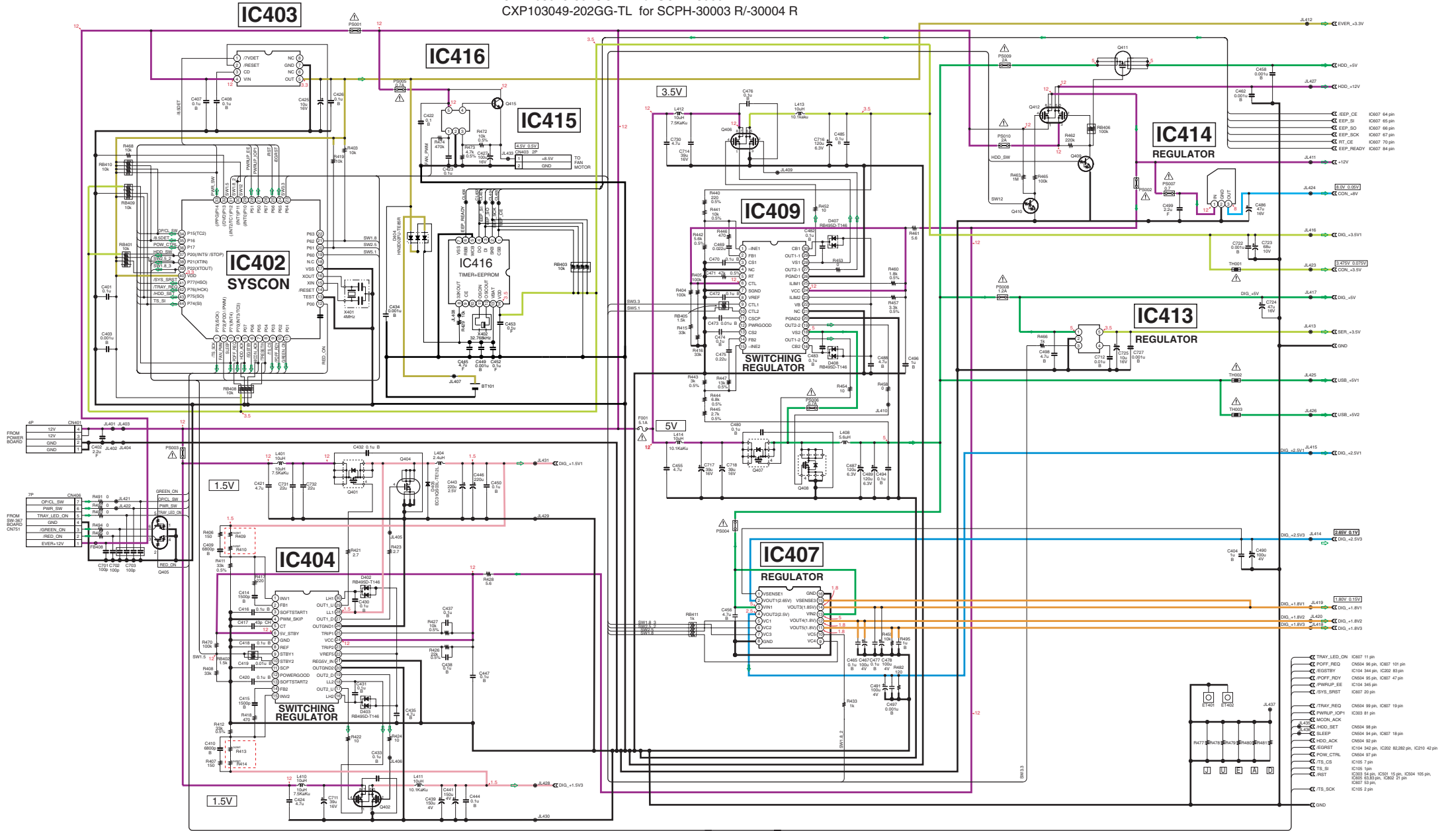

note1

	R409 & R414	R410 & R413
When C243 is mounted	: 0 ohm	33K ohm 0.5%
When C243 is not mounted	: 2.2K ohm	30K ohm 0.5%

F type model

GH-015(12/22)-2 (4/8)

Reproduction Prohibited

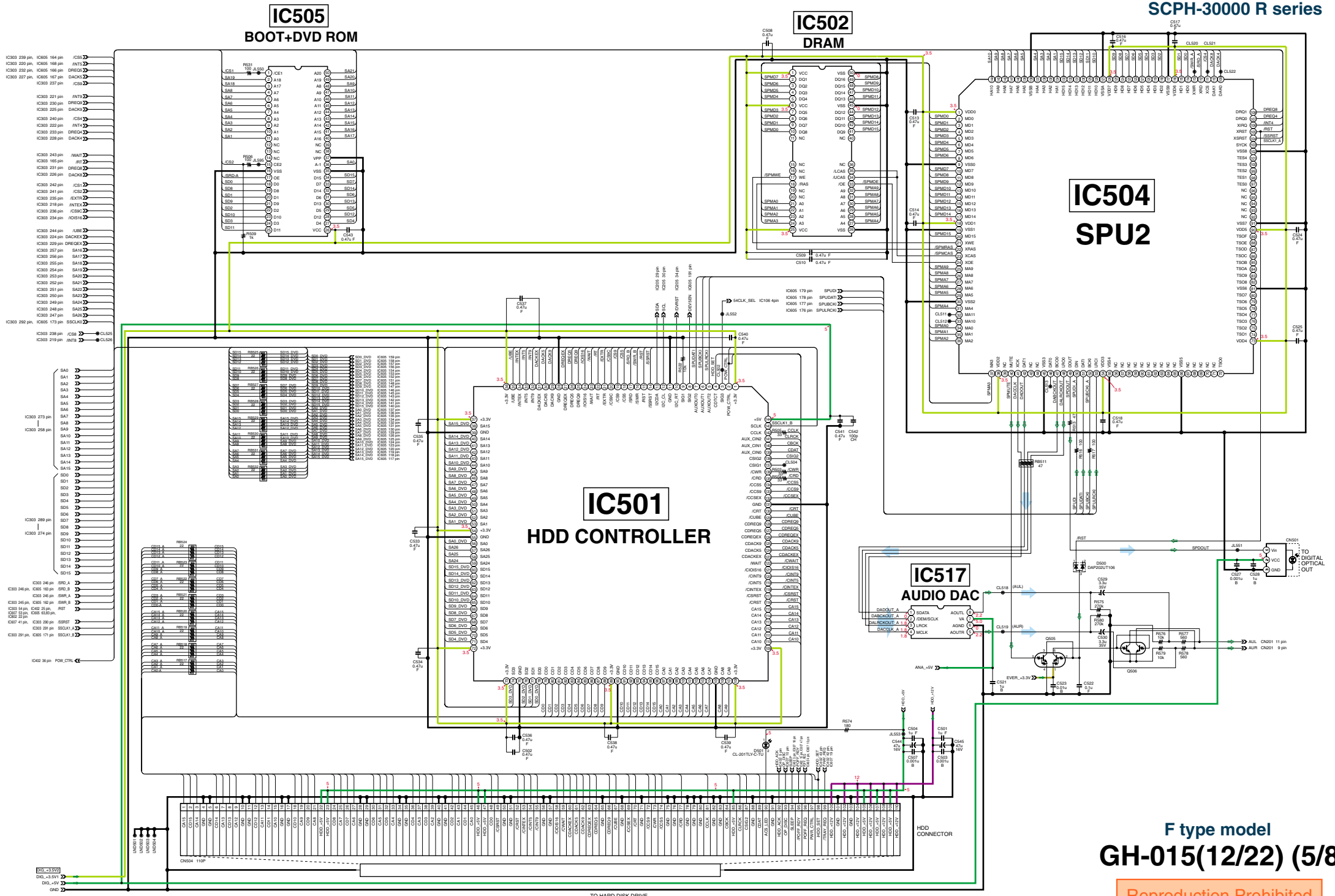

F type model
GH-015(12/22) (5/8)

Reproduction Prohibited

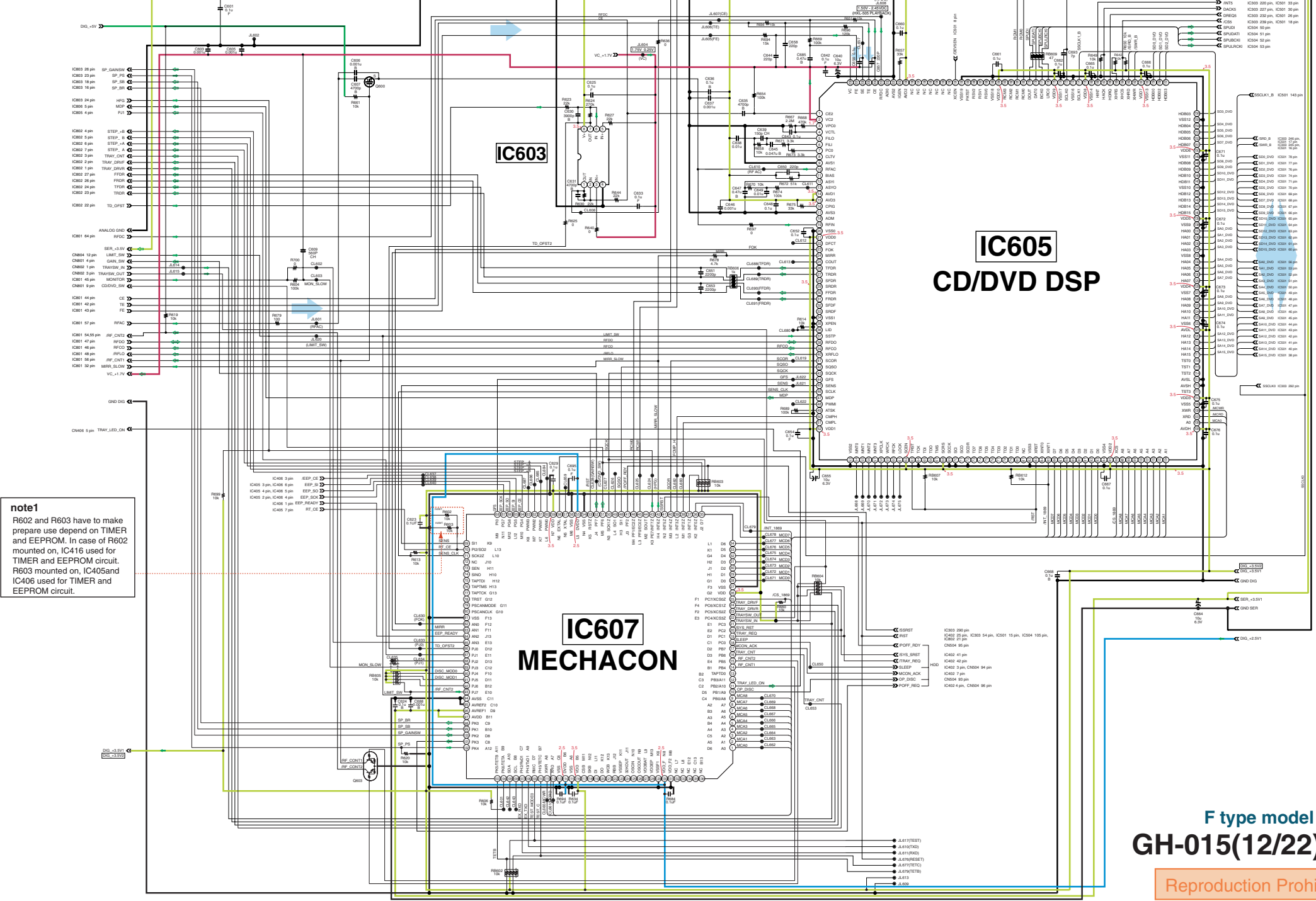

note1
R602 and R603 have to make prepare use depend on TIMER and EEPROM. In case of R602 mounted on, IC416 used for TIMER and EEPROM circuit. R603 mounted on, IC405 and IC406 used for TIMER and EEPROM circuit.

IC603

IC605
CD/DVD DSP

IC607
MECHACON

F type model
GH-015(12/22) (6/8)

Reproduction Prohibited

IC806

IC803
SPINDLE DRIVER

IC805

IC807
12V REG

IC801
RF AMP

IC802
FOCUS,
SLED & TRACKING
DRIVER

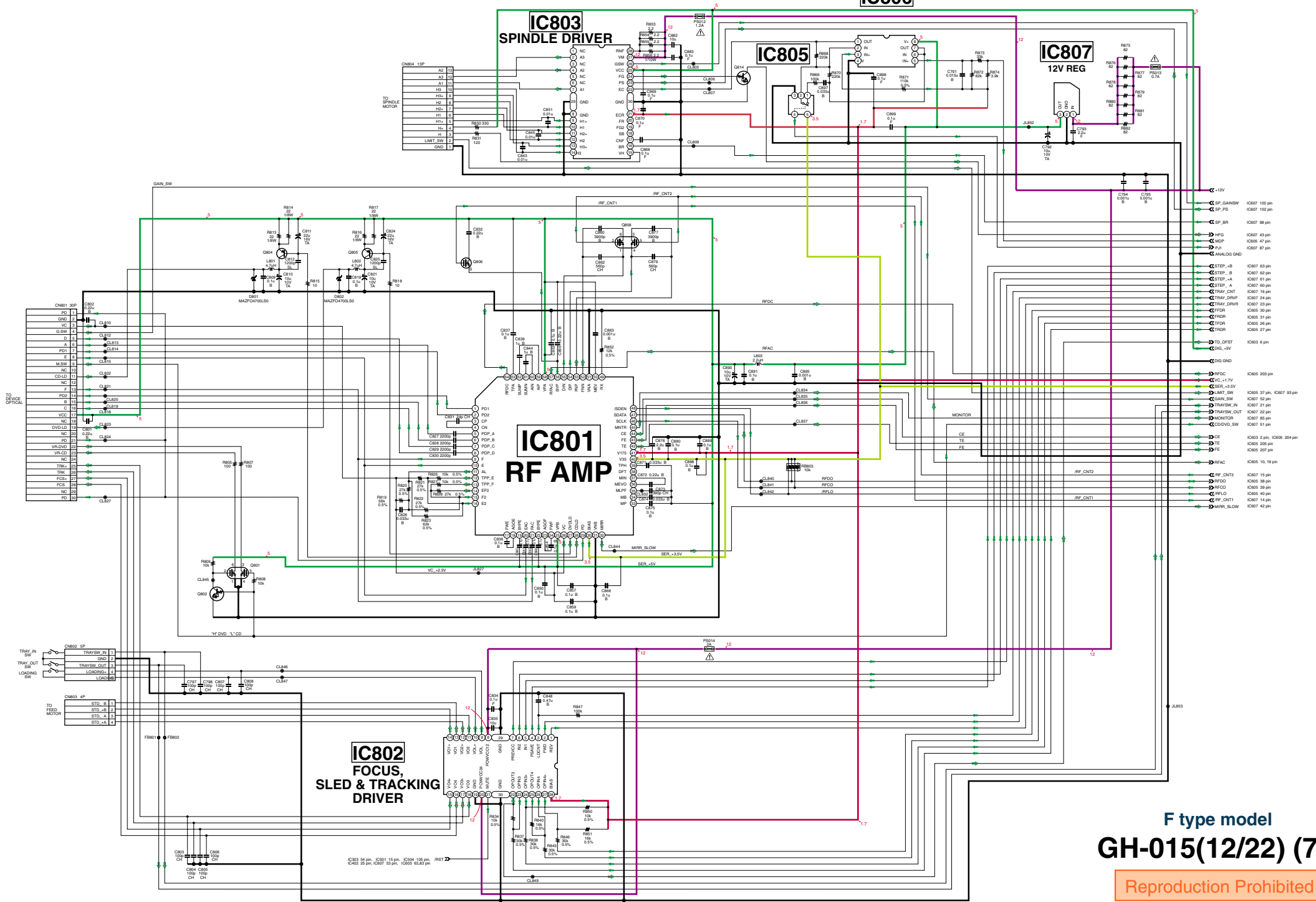

F type model
GH-015(12/22) (7/8)

Reproduction Prohibited

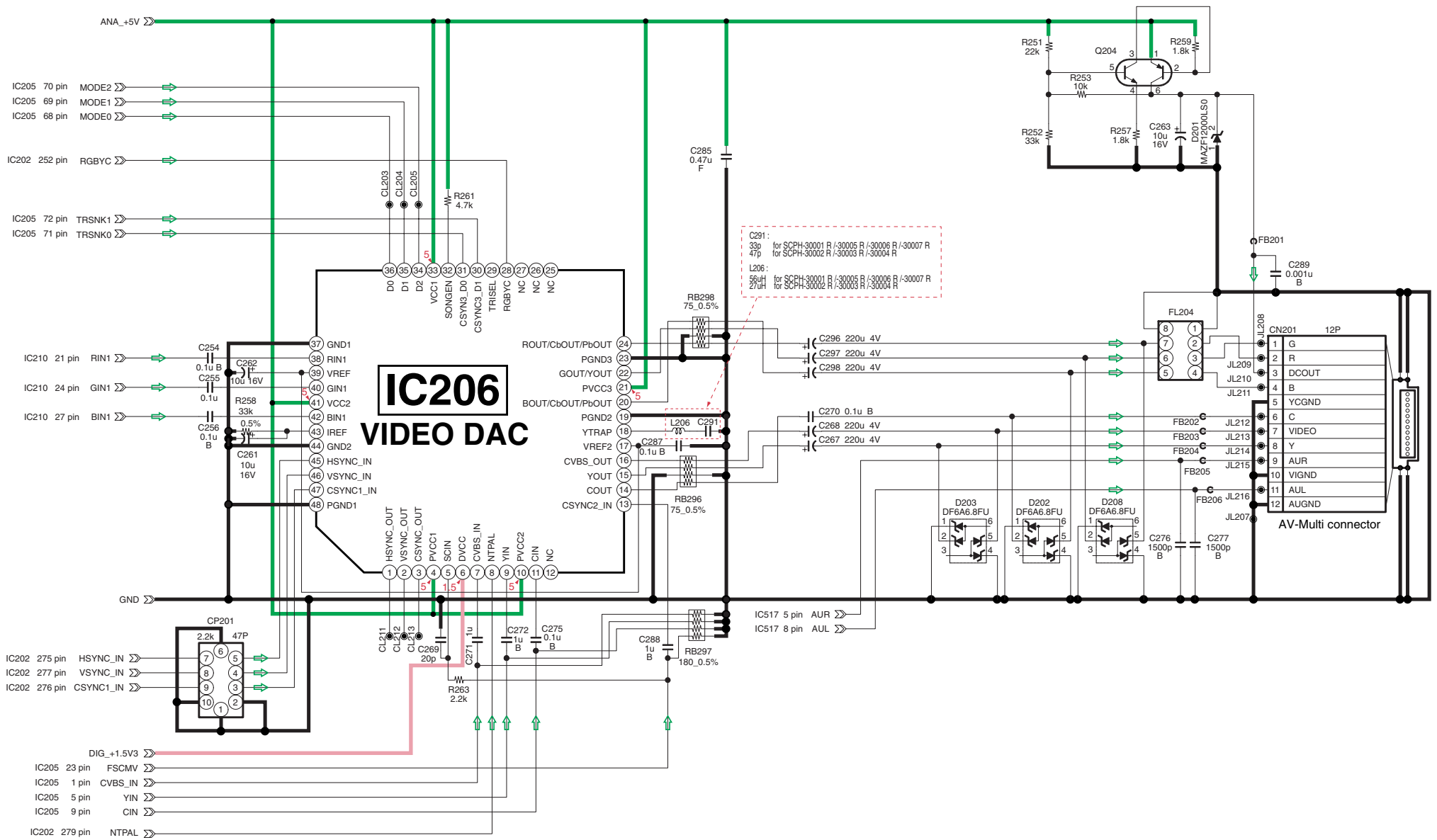

F type model
GH-015(12/22) (8/8)

Reproduction Prohibited

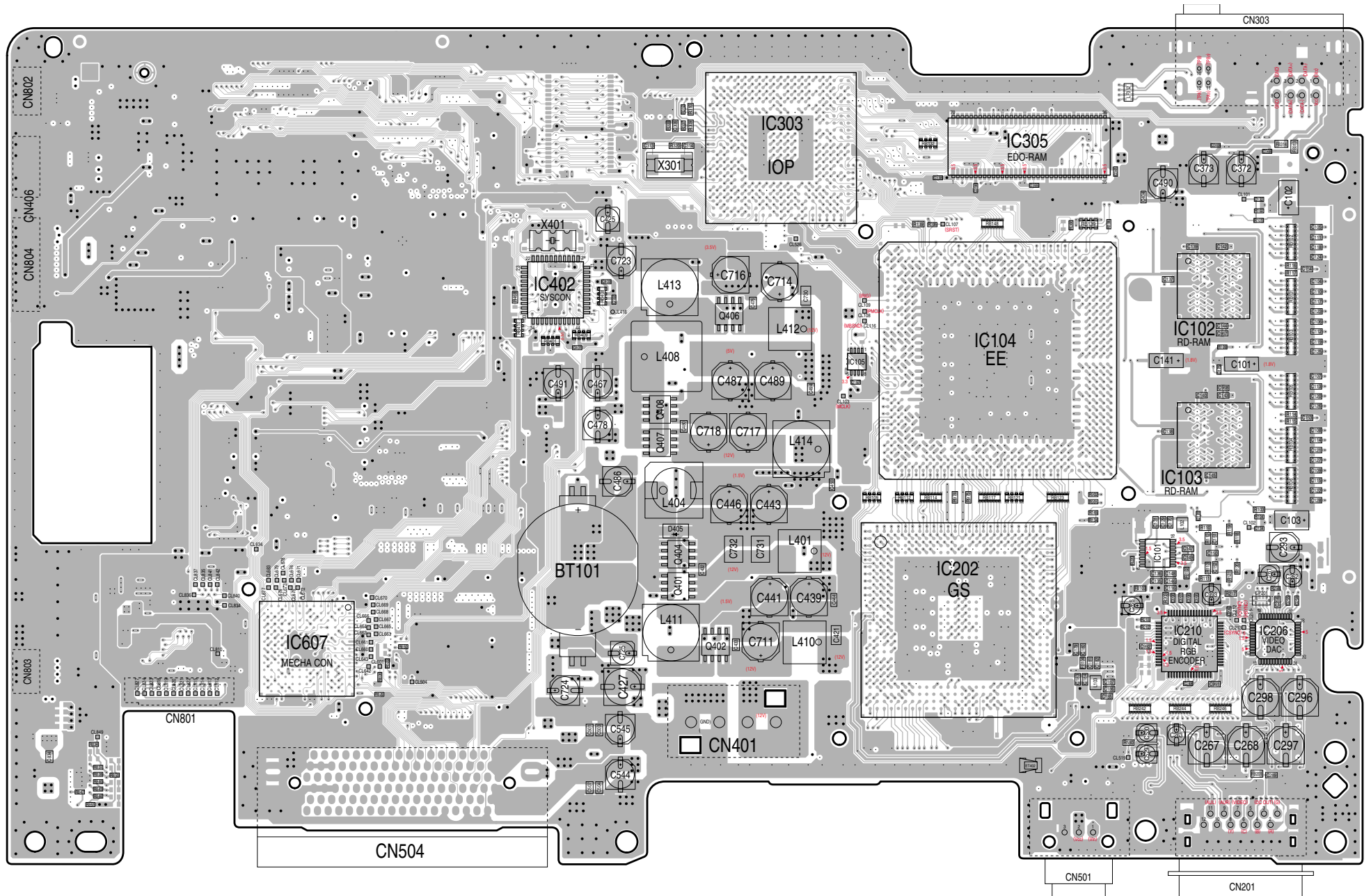

GH-015(12/22)

A side

Reproduction Prohibited

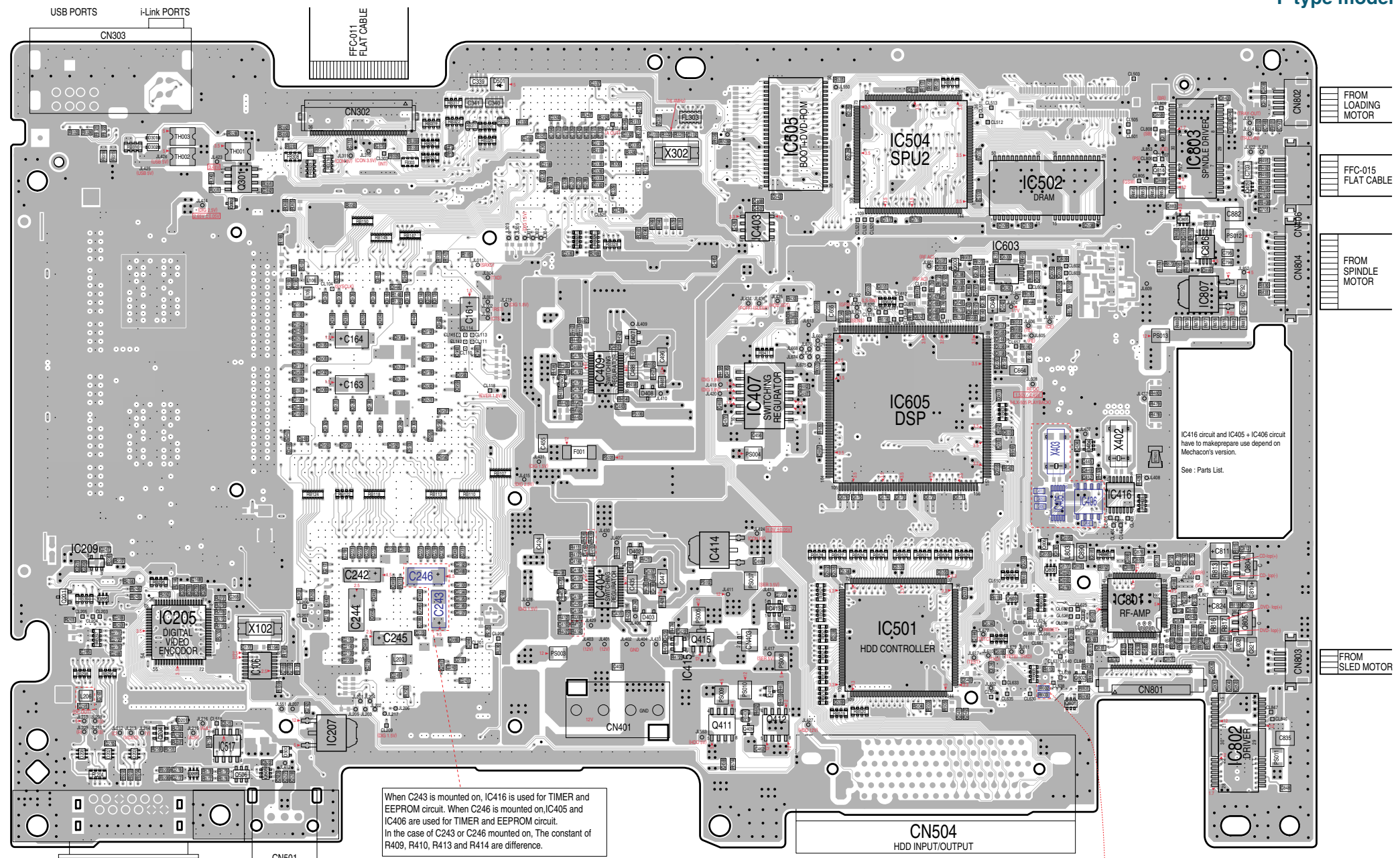

When C243 is mounted on, IC416 is used for TIMER and EEPROM circuit. When C246 is mounted on, IC405 and IC406 are used for TIMER and EEPROM circuit. In the case of C243 or C246 mounted on, The constant of R409, R410, R413 and R414 are difference.

IC416 circuit and IC405 + IC406 circuit have to make proper use depend on Mechcon's version.
See : Parts List.

CAUTION.
R602 and R603 have to make proper use depend on timer and EEPROM circuit.
When IC416 is mounted on, R602 has to on board.
When IC405 and IC406 are mounted on, R603 has to on board.

GH-015(12/22) B side

Reproduction Prohibited

ELECTRICAL PARTS LIST for GH015(12/22) MOUNT

NOTE :

- Due to standardization, replacements in the parts list may be different from the parts specified in the diagrams or the components used on the set.
- -XX and -X mean standardized parts, so they may have some difference from the original one.
- RESISTORS
METAL : Metal-film resistor
F : nonflammable
Unit is Ω.

- SEMICONDUCTORS
In each case, u : μ, for example :
uA ... : μA ... uPA ... : μPA ...
uPB ... : μPB ... uPC ... : μPC ... uPD ... : μPD ...
- CAPACITORS
uF : μF
• COILS
uH : μH

The components identified by mark Δ or dotted line with mark Δ are critical for safety. Replace only with part number specified.

CAUTION.

TIMER and EEPROM circuit are difference among the MECACON(IC607) VERSION.

Dissimilarity Parts List for GH015(12/22)MOUNT on SCPH-30000 R series F-type model

A-6714-501-A GH015(12/22) MOUNT on SCPH-30001 R(UC2) F-type model

Ref.	Part No.	Description	Remarks
IC607	8-752-928-26	IC CXP103049-102GG-TL	MECHACON
IC505	6-801-172-01	IC MR27V4812F-012TMZ	BOOT+DVD-ROM
IC505	6-801-195-01	IC K3NSV104SB-TCIAT00	BOOT+DVD-ROM
IC416	6-701-551-01	IC BU9861FV-WE2	TIMER+EEPROM
C445	1-117-720-91	CAP, CERAMIC 4.7MF F (2012)	
C449	1-162-964-91	CAP, CHIP CERAMIC 100PF B (1608)	
C452	1-164-156-91	CAP, CHIP CERAMIC 0.1MF F (1608)	
C453	1-164-156-91	CAP, CHIP CERAMIC 0.1MF F (1608)	
R429	1-216-833-91	RES, CHIP 10K (1608)	
R603	1-216-833-91	RES, CHIP 10K (1608)	
X403	1-760-928-41	VIBRATOR, CRYSTAL	
X403	1-767-300-21	VIBRATOR, CRYSTAL	
X403	1-781-266-41	VIBRATOR, CRYSTAL	
X403	1-782-266-61	VIBRATOR, CRYSTAL	
R478	1-216-833-91	RES, CHIP 10K (1608)	Mark for US model
C291	1-162-921-91	CAP, CERAMIC 33pF CH (1608)	
L206	1-412-960-21	INDUCTOR, SMALL TYPE 56UH (2518)	
C246	1-135-609-91	CAP, CHIP TANTALUM ELECT 220MF	
R409	1-218-855-91	RES, CHIP 2.2K (1608)	
R410	1-218-882-91	RES, CHIP 30K (1608)	
R413	1-218-882-91	RES, CHIP 30K (1608)	
R414	1-218-855-91	RES, CHIP 2.2K (1608)	
C212	1-107-826-91	CAP, CHIP CERAMIC 100000PF B (1608)	
C213	1-107-826-91	CAP, CHIP CERAMIC 100000PF B (1608)	
C214	1-107-826-91	CAP, CHIP CERAMIC 100000PF B (1608)	
C215	1-107-826-91	CAP, CHIP CERAMIC 100000PF B (1608)	
C216	1-107-826-91	CAP, CHIP CERAMIC 100000PF B (1608)	
C217	1-107-826-91	CAP, CHIP CERAMIC 100000PF B (1608)	
C218	1-107-826-91	CAP, CHIP CERAMIC 100000PF B (1608)	
C219	1-107-826-91	CAP, CHIP CERAMIC 100000PF B (1608)	
C220	1-107-826-91	CAP, CHIP CERAMIC 100000PF B (1608)	
C221	1-107-826-91	CAP, CHIP CERAMIC 100000PF B (1608)	
C222	1-107-826-91	CAP, CHIP CERAMIC 100000PF B (1608)	
C223	1-107-826-91	CAP, CHIP CERAMIC 100000PF B (1608)	
C224	1-107-826-91	CAP, CHIP CERAMIC 100000PF B (1608)	
C225	1-107-826-91	CAP, CHIP CERAMIC 100000PF B (1608)	
C226	1-107-826-91	CAP, CHIP CERAMIC 100000PF B (1608)	

Ref.	Part No.	Description	Remarks
C231	1-107-826-91	CAP, CHIP CERAMIC 100000PF B (1608)	
C232	1-107-826-91	CAP, CHIP CERAMIC 100000PF B (1608)	
C233	1-107-826-91	CAP, CHIP CERAMIC 100000PF B (1608)	
C234	1-107-826-91	CAP, CHIP CERAMIC 100000PF B (1608)	
C235	1-107-826-91	CAP, CHIP CERAMIC 100000PF B (1608)	
C236	1-107-826-91	CAP, CHIP CERAMIC 100000PF B (1608)	
C237	1-107-826-91	CAP, CHIP CERAMIC 100000PF B (1608)	
C238	1-107-826-91	CAP, CHIP CERAMIC 100000PF B (1608)	
C239	1-107-826-91	CAP, CHIP CERAMIC 100000PF B (1608)	
C240	1-107-826-91	CAP, CHIP CERAMIC 100000PF B (1608)	
C241	1-107-826-91	CAP, CHIP CERAMIC 100000PF B (1608)	
C990	1-107-826-91	CAP, CHIP CERAMIC 100000PF B (1608)	

Ref.	Part No.	Description	Remarks
IC607	8-752-928-45	IC CXP103049-101GG-TL	MECHACON
IC505	6-801-195-01	IC MR27V4812F-012TMZ	BOOT+DVD-ROM
IC505	6-801-172-01	IC K3NSV104SB-TCIAT00	BOOT+DVD-ROM
IC405	8-759-560-17	IC RS5C348A-E2	TIMER
IC406	8-759-698-67	IC BR2880F-E2	EEPROM
C411	1-117-720-91	CAP, CERAMIC 4.7MF F (2012)	
C406	1-162-964-91	CAP, CHIP CERAMIC 100PF B (1608)	
C405	1-164-156-91	CAP, CHIP CERAMIC 0.1MF F (1608)	
C454	1-164-156-91	CAP, CHIP CERAMIC 0.1MF F (1608)	
R602	1-216-833-91	RES, CHIP 10K (1608)	
X402	1-760-928-41	VIBRATOR, CRYSTAL	
X402	1-767-300-21	VIBRATOR, CRYSTAL	
X402	1-781-266-41	VIBRATOR, CRYSTAL	
X402	1-782-266-61	VIBRATOR, CRYSTAL	
R478	1-216-833-91	RES, CHIP 10K (1608)	Mark for US model
C291	1-162-921-91	CAP, CERAMIC 33pF CH (1608)	
L206	1-412-960-21	INDUCTOR, SMALL TYPE 56UH (2518)	
C243	1-135-609-91	CAP, CHIP TANTALUM ELECT 220MF	
R409	1-216-864-91	CONDUCTOR, CHIP (1608)	
R410	1-218-883-91	RES, CHIP 33K (1608)	

Ref.	Part No.	Description	Remarks
R413	1-218-883-91	RES, CHIP 33K (1608)	
R414	1-216-864-91	CONDUCTOR, CHIP (1608)	
C212	1-125-837-91	CAP, CHIP CERAMIC 1MF B (1608)	
C213	1-125-837-91	CAP, CHIP CERAMIC 1MF B (1608)	
C214	1-125-837-91	CAP, CHIP CERAMIC 1MF B (1608)	
C215	1-125-837-91	CAP, CHIP CERAMIC 1MF B (1608)	
C216	1-125-837-91	CAP, CHIP CERAMIC 1MF B (1608)	
C217	1-125-837-91	CAP, CHIP CERAMIC 1MF B (1608)	
C218	1-125-837-91	CAP, CHIP CERAMIC 1MF B (1608)	
C219	1-125-837-91	CAP, CHIP CERAMIC 1MF B (1608)	
C220	1-125-837-91	CAP, CHIP CERAMIC 1MF B (1608)	
C221	1-125-837-91	CAP, CHIP CERAMIC 1MF B (1608)	
C222	1-125-837-91	CAP, CHIP CERAMIC 1MF B (1608)	
C223	1-125-837-91	CAP, CHIP CERAMIC 1MF B (1608)	
C224	1-125-837-91	CAP, CHIP CERAMIC 1MF B (1608)	
C225	1-125-837-91	CAP, CHIP CERAMIC 1MF B (1608)	
C226	1-125-837-91	CAP, CHIP CERAMIC 1MF B (1608)	
C231	1-125-837-91	CAP, CHIP CERAMIC 1MF B (1608)	
C232	1-125-837-91	CAP, CHIP CERAMIC 1MF B (1608)	
C233	1-125-837-91	CAP, CHIP CERAMIC 1MF B (1608)	
C234	1-125-837-91	CAP, CHIP CERAMIC 1MF B (1608)	
C235	1-125-837-91	CAP, CHIP CERAMIC 1MF B (1608)	
C236	1-125-837-91	CAP, CHIP CERAMIC 1MF B (1608)	
C237	1-125-837-91	CAP, CHIP CERAMIC 1MF B (1608)	
C238	1-125-837-91	CAP, CHIP CERAMIC 1MF B (1608)	
C239	1-125-837-91	CAP, CHIP CERAMIC 1MF B (1608)	
C240	1-125-837-91	CAP, CHIP CERAMIC 1MF B (1608)	
C241	1-125-837-91	CAP, CHIP CERAMIC 1MF B (1608)	
C990	1-125-837-91	CAP, CHIP CERAMIC 1MF B (1608)	

Dissimilarity Parts List for GH015(12/22)MOUNT on SCPH-30000 R series F-type model

A-6714-504-AGH015(12/22) MOUNT on SCPH-30002 R(AU3) F-type model

Ref.	Part No.	Description	Remarks
IC607	8-752-930-05	IC CXP103049-302GG-TL	MECHACON
IC505	6-801-243-01	IC MR27V4812F-014TMZ	BOOT+DVD-ROM
IC416	6-701-551-01	IC BU9861FV-WE2	TIMER+EEPROM
C445	1-117-720-91	CAP, CERAMIC 4.7MF F (2012)	
C449	1-162-964-91	CAP, CHIP CERAMIC 100PF B (1608)	
C452	1-164-156-91	CAP, CHIP CERAMIC 0.1MF F (1608)	
C453	1-164-156-91	CAP, CHIP CERAMIC 0.1MF F (1608)	
R429	1-216-833-91	RES, CHIP 10K (1608)	
R603	1-216-833-91	RES, CHIP 10K (1608)	
X403	1-760-928-41	VIBRATOR, CRYSTAL	
X403	1-767-300-21	VIBRATOR, CRYSTAL	
X403	1-781-266-41	VIBRATOR, CRYSTAL	
X403	1-782-266-61	VIBRATOR, CRYSTAL	
R480	1-216-841-91	RES, CHIP 47K (1608)	Mark for AU3 model
C291	1-162-923-91	CAP, CERAMIC 47pF CH (1608)	
L206	1-412-956-21	INDUCTOR, SMALL TYPE 27uH (2518)	
C246	1-135-609-91	CAP, CHIP TANTALUM ELECT 220MF	
R409	1-218-855-91	RES, CHIP 2.2K (1608)	
R410	1-218-882-91	RES, CHIP 30K (1608)	
R413	1-218-882-91	RES, CHIP 30K (1608)	
R414	1-218-855-91	RES, CHIP 2.2K (1608)	
C212	1-107-826-91	CAP, CHIP CERAMIC 100000PF B (1608)	
C213	1-107-826-91	CAP, CHIP CERAMIC 100000PF B (1608)	
C214	1-107-826-91	CAP, CHIP CERAMIC 100000PF B (1608)	
C215	1-107-826-91	CAP, CHIP CERAMIC 100000PF B (1608)	
C216	1-107-826-91	CAP, CHIP CERAMIC 100000PF B (1608)	
C217	1-107-826-91	CAP, CHIP CERAMIC 100000PF B (1608)	
C218	1-107-826-91	CAP, CHIP CERAMIC 100000PF B (1608)	
C219	1-107-826-91	CAP, CHIP CERAMIC 100000PF B (1608)	
C220	1-107-826-91	CAP, CHIP CERAMIC 100000PF B (1608)	
C221	1-107-826-91	CAP, CHIP CERAMIC 100000PF B (1608)	
C222	1-107-826-91	CAP, CHIP CERAMIC 100000PF B (1608)	
C223	1-107-826-91	CAP, CHIP CERAMIC 100000PF B (1608)	
C224	1-107-826-91	CAP, CHIP CERAMIC 100000PF B (1608)	
C225	1-107-826-91	CAP, CHIP CERAMIC 100000PF B (1608)	
C226	1-107-826-91	CAP, CHIP CERAMIC 100000PF B (1608)	
C231	1-107-826-91	CAP, CHIP CERAMIC 100000PF B (1608)	
C232	1-107-826-91	CAP, CHIP CERAMIC 100000PF B (1608)	
C233	1-107-826-91	CAP, CHIP CERAMIC 100000PF B (1608)	
C234	1-107-826-91	CAP, CHIP CERAMIC 100000PF B (1608)	
C235	1-107-826-91	CAP, CHIP CERAMIC 100000PF B (1608)	
C236	1-107-826-91	CAP, CHIP CERAMIC 100000PF B (1608)	
C237	1-107-826-91	CAP, CHIP CERAMIC 100000PF B (1608)	
C238	1-107-826-91	CAP, CHIP CERAMIC 100000PF B (1608)	
C239	1-107-826-91	CAP, CHIP CERAMIC 100000PF B (1608)	
C240	1-107-826-91	CAP, CHIP CERAMIC 100000PF B (1608)	
C241	1-107-826-91	CAP, CHIP CERAMIC 100000PF B (1608)	
C990	1-107-826-91	CAP, CHIP CERAMIC 100000PF B (1608)	

Ref.	Part No.	Description	Remarks
IC607	8-752-929-46	IC CXP103049-301GG-TL	MECHACON
IC505	6-801-243-01	IC MR27V4812F-014TMZ	BOOT+DVD-ROM
IC405	8-759-560-17	IC RS5C348A-E2	TIMER
IC406	8-759-698-67	IC BR2880F-E2	EEPROM
C411	1-117-720-91	CAP, CERAMIC 4.7MF F (2012)	
C405	1-164-156-91	CAP, CHIP CERAMIC 0.1MF F (1608)	
C406	1-162-964-91	CAP, CHIP CERAMIC 100PF B (1608)	
C454	1-164-156-91	CAP, CHIP CERAMIC 0.1MF F (1608)	
R602	1-216-833-91	RES, CHIP 10K (1608)	
X402	1-760-928-41	VIBRATOR, CRYSTAL	
X402	1-767-300-21	VIBRATOR, CRYSTAL	
X402	1-781-266-41	VIBRATOR, CRYSTAL	
X402	1-782-266-61	VIBRATOR, CRYSTAL	
R480	1-216-841-91	RES, CHIP 47K (1608)	Mark for AU3 model
C291	1-162-923-91	CAP, CERAMIC 47pF CH (1608)	
L206	1-412-956-21	INDUCTOR, SMALL TYPE 27uH (2518)	
C243	1-135-609-91	CAP, CHIP TANTALUM ELECT 220MF	
R409	1-216-864-91	CONDUCTOR, CHIP (1608)	
R410	1-218-883-91	RES, CHIP 33K (1608)	
R413	1-218-883-91	RES, CHIP 33K (1608)	
R414	1-216-864-91	CONDUCTOR, CHIP (1608)	
C212	1-125-837-91	CAP, CHIP CERAMIC 1MF B (1608)	
C213	1-125-837-91	CAP, CHIP CERAMIC 1MF B (1608)	
C214	1-125-837-91	CAP, CHIP CERAMIC 1MF B (1608)	
C215	1-125-837-91	CAP, CHIP CERAMIC 1MF B (1608)	
C216	1-125-837-91	CAP, CHIP CERAMIC 1MF B (1608)	
C217	1-125-837-91	CAP, CHIP CERAMIC 1MF B (1608)	
C218	1-125-837-91	CAP, CHIP CERAMIC 1MF B (1608)	
C219	1-125-837-91	CAP, CHIP CERAMIC 1MF B (1608)	
C220	1-125-837-91	CAP, CHIP CERAMIC 1MF B (1608)	
C221	1-125-837-91	CAP, CHIP CERAMIC 1MF B (1608)	
C222	1-125-837-91	CAP, CHIP CERAMIC 1MF B (1608)	
C223	1-125-837-91	CAP, CHIP CERAMIC 1MF B (1608)	
C224	1-125-837-91	CAP, CHIP CERAMIC 1MF B (1608)	
C225	1-125-837-91	CAP, CHIP CERAMIC 1MF B (1608)	
C226	1-125-837-91	CAP, CHIP CERAMIC 1MF B (1608)	
C231	1-125-837-91	CAP, CHIP CERAMIC 1MF B (1608)	
C232	1-125-837-91	CAP, CHIP CERAMIC 1MF B (1608)	
C233	1-125-837-91	CAP, CHIP CERAMIC 1MF B (1608)	
C234	1-125-837-91	CAP, CHIP CERAMIC 1MF B (1608)	
C235	1-125-837-91	CAP, CHIP CERAMIC 1MF B (1608)	
C236	1-125-837-91	CAP, CHIP CERAMIC 1MF B (1608)	
C237	1-125-837-91	CAP, CHIP CERAMIC 1MF B (1608)	
C238	1-125-837-91	CAP, CHIP CERAMIC 1MF B (1608)	
C239	1-125-837-91	CAP, CHIP CERAMIC 1MF B (1608)	
C240	1-125-837-91	CAP, CHIP CERAMIC 1MF B (1608)	
C241	1-125-837-91	CAP, CHIP CERAMIC 1MF B (1608)	
C990	1-125-837-91	CAP, CHIP CERAMIC 1MF B (1608)	

Dissimilarity List for GH015(12/22)MOUNT on SCPH-30000 R series F-type model

A-6714-505-A
GH015(12/22) MOUNT on SCPH-30003 R(CEL)/-30004 R(CEK) F-type model

Ref.	Part No.	Description	Remarks
IC607	8-752-928-27	IC CXP103049-202GG-TL	MECHACON
IC505	6-801-242-01	IC MR27V4812F-013TMZ	BOOT+DVD-ROM
IC416	6-701-551-01	IC BU9861FV-WE2	TIMER+EEPROM
C445	1-117-720-91	CAP, CERAMIC 4.7MF F (2012)	
C449	1-162-964-91	CAP, CHIP CERAMIC 100PF B (1608)	
C452	1-164-156-91	CAP, CHIP CERAMIC 0.1MF F (1608)	
C453	1-164-156-91	CAP, CHIP CERAMIC 0.1MF F (1608)	
R429	1-216-833-91	RES, CHIP 10K (1608)	
R603	1-216-833-91	RES, CHIP 10K (1608)	
X403	1-760-928-41	VIBRATOR, CRYSTAL	
X403	1-767-300-21	VIBRATOR, CRYSTAL	
X403	1-781-266-41	VIBRATOR, CRYSTAL	
X403	1-782-266-61	VIBRATOR, CRYSTAL	
R479	1-216-837-91	RES,CHIP 22K (1608)	Mark for CEK model
C291	1-162-923-91	CAP, CERAMIC 47pF CH (1608)	
L206	1-412-956-21	INDUCTOR, SMALL TYPE 27uH (2518)	
C246	1-135-609-91	CAP, CHIP TANTALUM ELECT 220MF	
R409	1-218-855-91	RES, CHIP 2.2K (1608)	
R410	1-218-882-91	RES, CHIP 30K (1608)	
R413	1-218-882-91	RES, CHIP 30K (1608)	
R414	1-218-855-91	RES, CHIP 2.2K (1608)	
C212	1-107-826-91	CAP, CHIP CERAMIC 100000PF B (1608)	
C213	1-107-826-91	CAP, CHIP CERAMIC 100000PF B (1608)	
C214	1-107-826-91	CAP, CHIP CERAMIC 100000PF B (1608)	
C215	1-107-826-91	CAP, CHIP CERAMIC 100000PF B (1608)	
C216	1-107-826-91	CAP, CHIP CERAMIC 100000PF B (1608)	
C217	1-107-826-91	CAP, CHIP CERAMIC 100000PF B (1608)	
C218	1-107-826-91	CAP, CHIP CERAMIC 100000PF B (1608)	
C219	1-107-826-91	CAP, CHIP CERAMIC 100000PF B (1608)	
C220	1-107-826-91	CAP, CHIP CERAMIC 100000PF B (1608)	
C221	1-107-826-91	CAP, CHIP CERAMIC 100000PF B (1608)	
C222	1-107-826-91	CAP, CHIP CERAMIC 100000PF B (1608)	
C223	1-107-826-91	CAP, CHIP CERAMIC 100000PF B (1608)	
C224	1-107-826-91	CAP, CHIP CERAMIC 100000PF B (1608)	
C225	1-107-826-91	CAP, CHIP CERAMIC 100000PF B (1608)	
C226	1-107-826-91	CAP, CHIP CERAMIC 100000PF B (1608)	
C231	1-107-826-91	CAP, CHIP CERAMIC 100000PF B (1608)	
C232	1-107-826-91	CAP, CHIP CERAMIC 100000PF B (1608)	
C233	1-107-826-91	CAP, CHIP CERAMIC 100000PF B (1608)	
C234	1-107-826-91	CAP, CHIP CERAMIC 100000PF B (1608)	
C235	1-107-826-91	CAP, CHIP CERAMIC 100000PF B (1608)	
C236	1-107-826-91	CAP, CHIP CERAMIC 100000PF B (1608)	
C237	1-107-826-91	CAP, CHIP CERAMIC 100000PF B (1608)	
C238	1-107-826-91	CAP, CHIP CERAMIC 100000PF B (1608)	
C239	1-107-826-91	CAP, CHIP CERAMIC 100000PF B (1608)	
C240	1-107-826-91	CAP, CHIP CERAMIC 100000PF B (1608)	
C241	1-107-826-91	CAP, CHIP CERAMIC 100000PF B (1608)	
C990	1-107-826-91	CAP, CHIP CERAMIC 100000PF B (1608)	

Ref.	Part No.	Description	Remarks
IC607	8-752-929-37	IC CXP103049-201GG-TL	MECHACON
IC505	6-801-242-01	IC MR27V4812F-013TMZ	BOOT+DVD-ROM
IC405	8-759-560-17	IC RS5C348A-E2	TIMER
C406	8-759-698-67	IC BR2880F-E2	EEPROM
C411	1-117-720-91	CAP, CERAMIC 4.7MF F (2012)	
C406	1-162-964-91	CAP, CHIP CERAMIC 100PF B (1608)	
C405	1-164-156-91	CAP, CHIP CERAMIC 0.1MF F (1608)	
C454	1-164-156-91	CAP, CHIP CERAMIC 0.1MF F (1608)	
R602	1-216-833-91	RES, CHIP 10K (1608)	
X402	1-760-928-41	VIBRATOR, CRYSTAL	
X402	1-767-300-21	VIBRATOR, CRYSTAL	
X402	1-781-266-41	VIBRATOR, CRYSTAL	
X402	1-782-266-61	VIBRATOR, CRYSTAL	
R479	1-216-837-91	RES,CHIP 22K (1608)	Mark for CEK model
C291	1-162-923-91	CAP, CERAMIC 47pF CH (1608)	
L206	1-412-956-21	INDUCTOR, SMALL TYPE 27uH (2518)	
C243	1-135-609-91	CAP, CHIP TANTALUM ELECT 220MF	
R409	1-216-864-91	CONDUCTOR, CHIP (1608)	
R410	1-218-883-91	RES, CHIP 33K (1608)	
R413	1-218-883-91	RES, CHIP 33K (1608)	
R414	1-216-864-91	CONDUCTOR, CHIP (1608)	
C212	1-125-837-91	CAP, CHIP CERAMIC 1MF B (1608)	
C213	1-125-837-91	CAP, CHIP CERAMIC 1MF B (1608)	
C214	1-125-837-91	CAP, CHIP CERAMIC 1MF B (1608)	
C215	1-125-837-91	CAP, CHIP CERAMIC 1MF B (1608)	
C216	1-125-837-91	CAP, CHIP CERAMIC 1MF B (1608)	
C217	1-125-837-91	CAP, CHIP CERAMIC 1MF B (1608)	
C218	1-125-837-91	CAP, CHIP CERAMIC 1MF B (1608)	
C219	1-125-837-91	CAP, CHIP CERAMIC 1MF B (1608)	
C220	1-125-837-91	CAP, CHIP CERAMIC 1MF B (1608)	
C221	1-125-837-91	CAP, CHIP CERAMIC 1MF B (1608)	
C222	1-125-837-91	CAP, CHIP CERAMIC 1MF B (1608)	
C223	1-125-837-91	CAP, CHIP CERAMIC 1MF B (1608)	
C224	1-125-837-91	CAP, CHIP CERAMIC 1MF B (1608)	
C225	1-125-837-91	CAP, CHIP CERAMIC 1MF B (1608)	
C226	1-125-837-91	CAP, CHIP CERAMIC 1MF B (1608)	
C231	1-125-837-91	CAP, CHIP CERAMIC 1MF B (1608)	
C232	1-125-837-91	CAP, CHIP CERAMIC 1MF B (1608)	
C233	1-125-837-91	CAP, CHIP CERAMIC 1MF B (1608)	
C234	1-125-837-91	CAP, CHIP CERAMIC 1MF B (1608)	
C235	1-125-837-91	CAP, CHIP CERAMIC 1MF B (1608)	
C236	1-125-837-91	CAP, CHIP CERAMIC 1MF B (1608)	
C237	1-125-837-91	CAP, CHIP CERAMIC 1MF B (1608)	
C238	1-125-837-91	CAP, CHIP CERAMIC 1MF B (1608)	
C239	1-125-837-91	CAP, CHIP CERAMIC 1MF B (1608)	
C240	1-125-837-91	CAP, CHIP CERAMIC 1MF B (1608)	
C241	1-125-837-91	CAP, CHIP CERAMIC 1MF B (1608)	
C990	1-125-837-91	CAP, CHIP CERAMIC 1MF B (1608)	

Ref.	Part No.	Description	
R805	1-216-809-91	RES, CHIP 100	(1608)
R806	1-216-833-91	RES, CHIP 10K	(1608)
R807	1-216-809-91	RES, CHIP 100	(1608)
R808	1-216-833-91	RES, CHIP 10K	(1608)
R813	1-216-158-91	RES, CHIP 22	(3216)
R814	1-216-158-91	RES, CHIP 22	(3216)
R815	1-216-797-91	RES, CHIP 10	(1608)
R816	1-216-158-91	RES, CHIP 22	(3216)
R817	1-216-158-91	RES, CHIP 22	(3216)
R818	1-216-797-91	RES, CHIP 10	(1608)
R819	1-218-889-91	RES, CHIP 56K	(1608)
R820	1-218-881-91	RES, CHIP 27K	(1608)
R821	1-218-881-91	RES, CHIP 27K	(1608)
R822	1-218-881-91	RES, CHIP 27K	(1608)
R823	1-218-890-91	RES, CHIP 62K	(1608)
R826	1-218-871-91	RES, CHIP 10K	(1608)
R827	1-218-871-91	RES, CHIP 10K	(1608)
R828	1-218-881-91	RES, CHIP 27K	(1608)
R830	1-216-815-91	RES, CHIP 330	(1608)
R831	1-216-810-91	RES, CHIP 120	(1608)
R834	1-208-911-81	RES, CHIP 10K	(1005)
R837	1-208-922-81	RES, CHIP 30K	(1005)
R838	1-208-922-81	RES, CHIP 30K	(1005)
R840	1-208-916-81	RES, CHIP 16K	(1005)
R843	1-208-922-81	RES, CHIP 30K	(1005)
R846	1-208-922-81	RES, CHIP 30K	(1005)
R847	1-218-977-81	RES, CHIP 100K	
R850	1-208-911-81	RES, CHIP 10K	(1005)
R851	1-208-916-81	RES, CHIP 16K	(1005)
R852	1-218-873-91	RES, CHIP 12K	(1608)
R853	1-216-298-91	RES, CHIP 2.2	(2012)
R854	1-216-298-91	RES, CHIP 2.2	(2012)
R855	1-216-298-91	RES, CHIP 2.2	(2012)
R856	1-216-298-91	RES, CHIP 2.2	(2012)
R866	1-216-845-91	RES, CHIP 100K	(1608)
R868	1-216-849-91	RES, CHIP 220K	(1608)
R870	1-216-849-91	RES, CHIP 220K	(1608)
R871	1-218-896-91	RES, CHIP 110K	(1608)
R872	1-216-844-91	RES, CHIP 82K	(1608)
R873	1-216-839-91	RES, CHIP 33K	(1608)
R874	1-216-828-91	RES, CHIP 3.9K	(1608)
R875	1-216-023-91	RES, CHIP 82	(2012)
R876	1-216-023-91	RES, CHIP 82	(2012)
R877	1-216-023-91	RES, CHIP 82	(2012)
R878	1-216-023-91	RES, CHIP 82	(2012)
R879	1-216-023-91	RES, CHIP 82	(2012)
R880	1-216-023-91	RES, CHIP 82	(2012)
R881	1-216-023-91	RES, CHIP 82	(2012)
R882	1-216-023-91	RES, CHIP 82	(2012)
R901	1-218-937-81	RES, CHIP 47	
R902	1-218-937-81	RES, CHIP 47	
R974	1-216-801-91	RES, CHIP 22	(1608)
R975	1-216-801-91	RES, CHIP 22	(1608)
<RESISTOR BLOCK>			
RB101	1-234-496-21	ARRAY, RESISTOR 39	
RB102	1-234-496-21	ARRAY, RESISTOR 39	
RB103	1-234-496-21	ARRAY, RESISTOR 39	
RB104	1-234-496-21	ARRAY, RESISTOR 39	
RB105	1-234-496-21	ARRAY, RESISTOR 39	
RB106	1-234-496-21	ARRAY, RESISTOR 39	
RB107	1-234-710-21	RES, CHIP NETWORK 47X8	(3816)
RB109	1-233-423-21	RES, CHIP NETWORK 47	(3216)
RB110	1-234-710-21	RES, CHIP NETWORK 47X8	(3816)
RB112	1-233-423-21	RES, CHIP NETWORK 47	(3216)

Ref.	Part No.	Description	
RB113	1-234-710-21	RES, CHIP NETWORK 47X8	(3816)
RB114	1-234-710-21	RES, CHIP NETWORK 47X8	(3816)
RB117	1-234-710-21	RES, CHIP NETWORK 47X8	(3816)
RB118	1-234-710-21	RES, CHIP NETWORK 47X8	(3816)
RB121	1-233-423-21	RES, CHIP NETWORK 47	(3216)
RB122	1-233-423-21	RES, CHIP NETWORK 47	(3216)
RB123	1-234-710-21	RES, CHIP NETWORK 47X8	(3816)
RB124	1-234-710-21	RES, CHIP NETWORK 47X8	(3816)
RB139	1-233-414-21	RES, CHIP NETWORK 4.7K	(3216)
RB147	1-234-710-21	RES, CHIP NETWORK 47X8	(3816)
RB148	1-234-710-21	RES, CHIP NETWORK 47X8	(3816)
RB149	1-234-710-21	RES, CHIP NETWORK 47X8	(3816)
RB150	1-234-710-21	RES, CHIP NETWORK 47X8	(3816)
RB242	1-234-710-21	RES, CHIP NETWORK 47X8	(3816)
RB244	1-234-710-21	RES, CHIP NETWORK 47X8	(3816)
RB246	1-234-710-21	RES, CHIP NETWORK 47X8	(3816)
RB295	1-233-412-21	RES, CHIP NETWORK 1.0K	(3216)
RB296	1-234-598-21	RES, CHIP NETWORK 75X4	(3216)
RB297	1-234-599-21	RES, CHIP NETWORK 180X4	(3216)
RB298	1-234-598-21	RES, CHIP NETWORK 75X4	(3216)
RB303	1-233-412-21	RES, CHIP NETWORK 1.0K	(3216)
RB310	1-233-414-21	RES, CHIP NETWORK 4.7K	(3216)
RB311	1-233-679-91	RES, NETWORK (1608) 470	
RB312	1-233-786-91	RES, NETWORK 220	(1608)
RB314	1-233-681-91	RES, NETWORK (1608) 4.7K	
RB317	1-233-423-21	RES, CHIP NETWORK 47	(3216)
RB318	1-233-423-21	RES, CHIP NETWORK 47	(3216)
RB319	1-233-423-21	RES, CHIP NETWORK 47	(3216)
RB320	1-233-423-21	RES, CHIP NETWORK 47	(3216)
RB321	1-233-423-21	RES, CHIP NETWORK 47	(3216)
RB322	1-233-412-21	RES, CHIP NETWORK 1.0K	(3216)
RB323	1-233-412-21	RES, CHIP NETWORK 1.0K	(3216)
RB324	1-233-412-21	RES, CHIP NETWORK 1.0K	(3216)
RB325	1-233-412-21	RES, CHIP NETWORK 1.0K	(3216)
RB326	1-233-412-21	RES, CHIP NETWORK 1.0K	(3216)
RB327	1-233-415-21	RES, CHIP NETWORK 10K	(3216)
RB328	1-233-414-21	RES, CHIP NETWORK 4.7K	(3216)
RB332	1-233-575-21	RES, CHIP NETWORK 22	
RB401	1-233-415-21	RES, CHIP NETWORK 10K	(3216)
RB402	1-233-803-91	RES, NETWORK 1.5K	(1608)
RB403	1-233-415-21	RES, CHIP NETWORK 10K	(3216)
RB405	1-233-803-91	RES, NETWORK 1.5K	(1608)
RB406	1-233-792-91	RES, NETWORK 100K	(1608)
RB408	1-233-415-21	RES, CHIP NETWORK 10K	(3216)
RB409	1-233-415-21	RES, CHIP NETWORK 10K	(3216)
RB410	1-233-415-21	RES, CHIP NETWORK 10K	(3216)
RB411	1-233-412-21	RES, CHIP NETWORK 1.0K	(3216)
RB511	1-233-423-21	RES, CHIP NETWORK 47	(3216)
RB517	1-233-575-21	RES, CHIP NETWORK 22	
RB518	1-233-575-21	RES, CHIP NETWORK 22	
RB519	1-233-575-21	RES, CHIP NETWORK 22	
RB520	1-233-575-21	RES, CHIP NETWORK 22	
RB521	1-233-575-21	RES, CHIP NETWORK 22	
RB522	1-233-575-21	RES, CHIP NETWORK 22	
RB523	1-233-575-21	RES, CHIP NETWORK 22	
RB524	1-233-575-21	RES, CHIP NETWORK 22	
RB525	1-233-575-21	RES, CHIP NETWORK 22	
RB526	1-233-575-21	RES, CHIP NETWORK 22	
RB527	1-233-575-21	RES, CHIP NETWORK 22	
RB528	1-233-575-21	RES, CHIP NETWORK 22	
RB529	1-233-575-21	RES, CHIP NETWORK 22	
RB530	1-233-575-21	RES, CHIP NETWORK 22	
RB531	1-233-575-21	RES, CHIP NETWORK 22	
RB532	1-233-575-21	RES, CHIP NETWORK 22	
RB602	1-233-415-21	RES, CHIP NETWORK 10K	(3216)
RB603	1-233-415-21	RES, CHIP NETWORK 10K	(3216)

Ref.	Part No.	Description	
RB604	1-233-415-21	RES, CHIP NETWORK 10K	(3216)
RB605	1-233-415-21	RES, CHIP NETWORK 10K	(3216)
RB606	1-233-412-21	RES, CHIP NETWORK 1.0K	(3216)
RB609	1-233-423-21	RES, CHIP NETWORK 47	(3216)
RB803	1-233-415-21	RES, CHIP NETWORK 10K	(3216)
<THERMISTOR>			
△ TH001	1-533-817-21	THERMISTOR	
△ TH001	1-804-384-21	THERMISTOR, POSITIVE	
△ TH001	1-804-384-31	THERMISTOR, POSITIVE	
△ TH002	1-533-817-21	THERMISTOR	
△ TH002	1-804-384-21	THERMISTOR, POSITIVE	
△ TH002	1-804-384-31	THERMISTOR, POSITIVE	
△ TH003	1-533-817-21	THERMISTOR	
△ TH003	1-804-384-21	THERMISTOR, POSITIVE	
△ TH003	1-804-384-31	THERMISTOR, POSITIVE	
<CRYSTAL>			
X102	1-781-640-21	VIBRATOR, CRYSTAL	
X102	1-781-640-41	VIBRATOR, CRYSTAL	
X301	1-781-856-21	VIBRATOR, CRYSTAL	
X301	1-781-856-41	VIBRATOR, CRYSTAL	
X302	1-781-768-21	VIBRATOR, CRYSTAL	
Y401	1-760-496-22	VIBRATOR, LITHIUM NIOBATE	

Ref.	Part No.	Description
------	----------	-------------

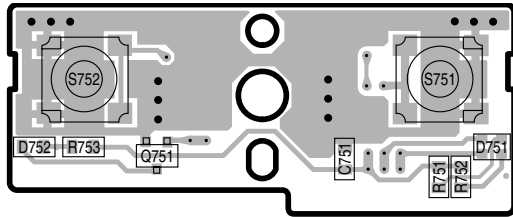

SW-367
A side

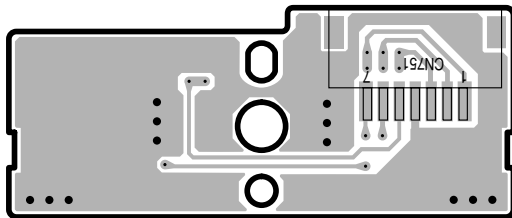

SW-367
B side

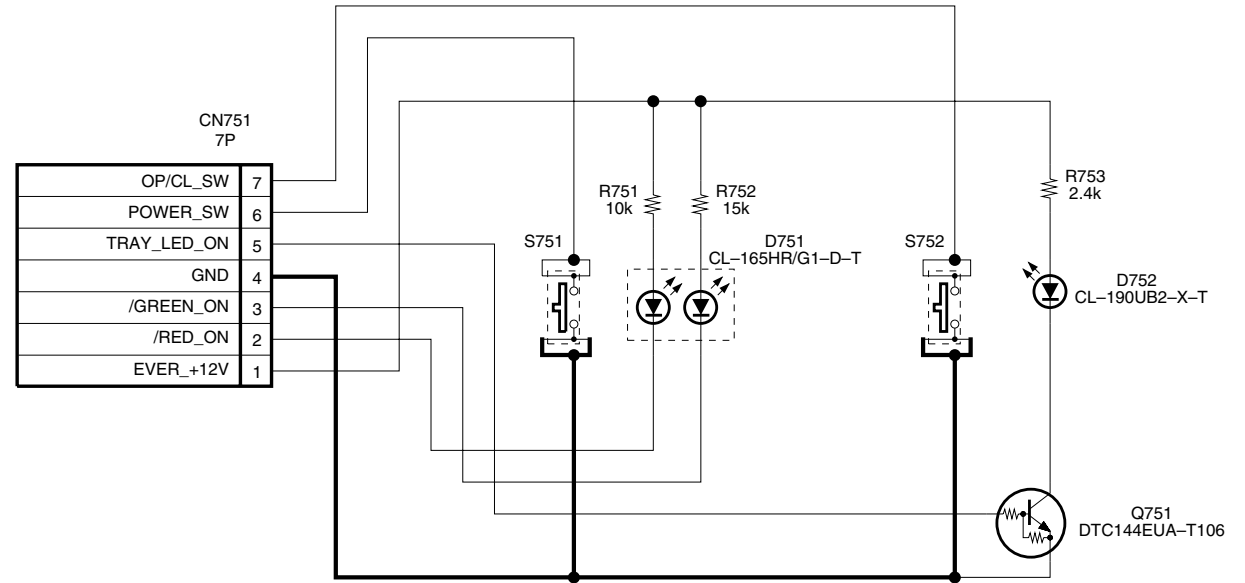

SW-367

SWITCH MOUNTED CIRCUIT BOARD

Ref-No.	Part No.	Description	Remark	Place code
PWB	1-683-435-11	PWB, SW-367		
PWB	1-683-435-21	PWB, SW-367		
CN751	1-785-470-21	CONNECTOR, FPC (LIF (NON-ZIF) 7P		
D751	8-719-078-90	DIODE CL-165HR/G1-D-T		
D752	6-500-240-01	DIODE CL-190UB2-X-T		
Q751	8-729-013-97	TRANSISTOR RN1304-TE85L		
Q751	8-729-029-14	TRANSISTOR DTC144EUA-T106		
Q751	8-729-402-44	TRANSISTOR UN5213-TX		
R751	1-216-833-91	RES, CHIP 10K (1608)		
R752	1-216-835-91	RES, CHIP 15K (1608)		
R753	1-216-993-91	RES, CHIP 2.4K (1608)		
S751	1-771-917-21	SWITCH, TACTILE		
S752	1-771-917-21	SWITCH, TACTILE		